

SCHEDULE

Crowne Plaza He Fei



HBA

HIRSCH/BEDNER
ASSOCIATES
DESIGN CONSULTANTS

17/ 46 DOUGLAS ST.
MILTON 4064
QUEENSLAND
AUSTRALIA
FAX 62.3858.5699
■ TEL 617.3858.5688 ■
www.HBAdesign.com

Presidential Suite Sanitary

Issued: 17-Dec-10

Project No.	5908
Series	300
Type	BH

J:\5908 Crowne Plaza Hefei\DOC\Guestroom\Plans\PS1.00_PS_Plan.dwg 12-17-10 11:25:36 AM MobYn

NOTE: FOR ALL DESIGN INTENT ONLY CONTRACTORS TO SUBMIT SHOP DRAWINGS TO HBA FOR APPROVAL PRIOR TO CONSTRUCTION. VERIFY ALL DIMENSIONS ON SITE. REPORT ANY DISCREPANCY TO HBA DESIGNER. WATER PROOF/NON SLIP MATERIAL TO ALL WET AREAS. EXTERNAL WINDOW & DOOR INFORMATION TO BE CONFIRMED BY ARCHITECT.

* 施工前供应商需向HBA提供施工图
* 现场核实所有尺寸,任何差异需通知HBA设计师
* 所有湿区必须使用防水或防滑材料
* 外部的窗和门资料由建筑师确认

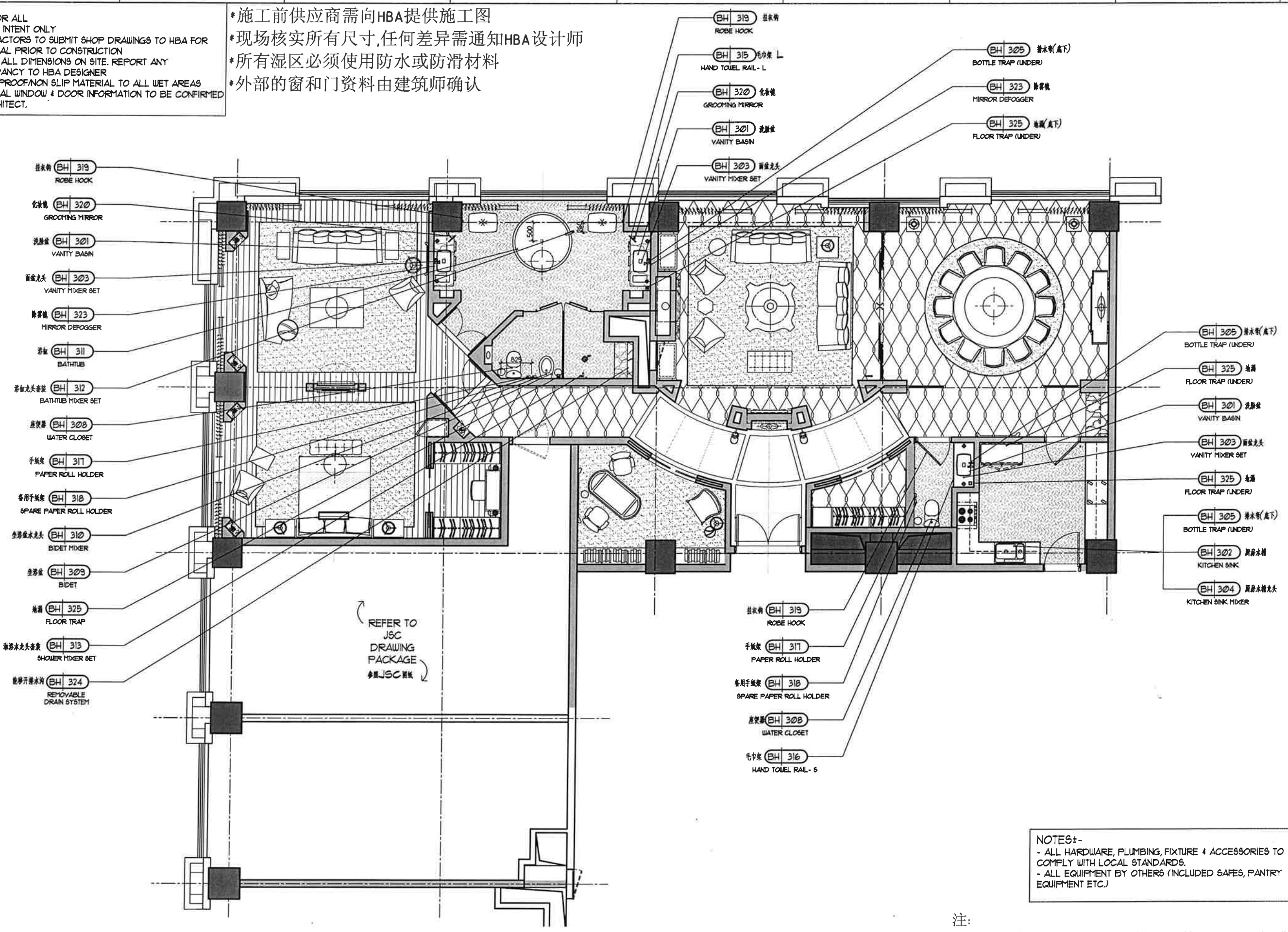

BH ROYAL SUITE - BATHROOM HARDWARE PLAN
Scale 1 : 50 @ A1 / 1:100(A3)
家具/装置平面图

NOTES:-
- ALL HARDWARE, PLUMBING, FIXTURE & ACCESSORIES TO COMPLY WITH LOCAL STANDARDS.
- ALL EQUIPMENT BY OTHERS (INCLUDED SAFES, PANTRY EQUIPMENT ETC.)

注:
- 所有硬件、配管、装置 & 辅助部件依从地方标准。
- 所有设备由其他人(包括 保险柜, 餐具室设备等。)

PRELIMINARY
17/12/10 初步

HBA

CROWNE PLAZA HEFEI
HEHU, PRC
皇冠假日酒店 合肥·中国

26层
总统套房
卫浴器具平面图

LEVEL 26
ROYAL SUITE
BH PLAN

APPROVED A.J.
DRAWN BY CA
DATE DEC 2010
SCALE 1:50
SHEET No.
PROJECT No.
5908

PS1.05

HIRSCH/BEDNER AND ASSOCIATES - DESIGN CONSULTANTS - LEVEL 1, 29 BAXTER ST., FORTITUDE VALLEY - QLD 4006 AUSTRALIA - TEL 617 3960 8698 - FAX 617 3960 8699

SCHEDULE



HBA

HIRSCH/BEDNER
ASSOCIATES
DESIGN CONSULTANTS

17/ 46 DOUGLAS ST.
MILTON 4064
QUEENSLAND
AUSTRALIA
FAX 62.3858.5699
■ TEL 617.3858.5688 ■
www.HBAdesign.com

Bath & Room Hardware

Ref. No.	Item	Qty.	Unit	Rev.
BH-301	Vanity Basin	2	Each	
BH-302	Kitchen Sink	1	Each	
BH-303	Vanity Mixer	2	Each	
BH-304	Kitchen Sink Mixer	1	Each	
BH-305	Bottle Trap	4	Each	
BH-306	...Open...			
BH-307	...Open...			
BH-308	Water Closet	2	Each	
BH-309	Bidet	1	Each	
BH-310	Bidet Mixer	1	Each	
BH-311	Bathtub III	1	Each	
BH-312	Bathtub Mixer Set II	1	Set	
BH-313	Shower Set	1	Set	
BH-314	...Open...			
BH-315	Hand Towel Rail - L	6	Each	
BH-316	Hand Towel Rail - S	3	Each	
BH-317	Paper Roll Holder	2	Each	
BH-318	Spare Paper Roll Holder	2	Each	
BH-319	Robe Hook	3	Each	
BH-320	Grooming Mirror	2	Each	
BH-321	...Open...			

Issued: 17-Dec-10

Project

Crowne Plaza He Fei

Area:

Presidential Suite Sanitary

Project No.	5908
Series	300
Type	BH

Bath & Room Hardware

Ref. No.	Item	Qty.	Unit	Rev.
BH-322	...Open...			
BH-323	Mirror Defogger	2	Each	
BH-324	Drain System	1	Each	
BH-325	Floor Trap	4	Each	

**HBA**HIRSCH/BEDNER
ASSOCIATES
DESIGN CONSULTANTS17/ 46 DOUGLAS ST.
MILTON 4064
QUEENSLAND
AUSTRALIA
FAX 62.3858.5699
■ TEL 617.3858.5688 ■
www.HBAdesign.com

Issued: 17-Dec-10

Project

Crowne Plaza He Fei

Area:

Presidential Suite Sanitary

Project No.	5908
Series	300
Type	BH

SPECIFICATION



HBA

HIRSCH/BEDNER
ASSOCIATES
DESIGN CONSULTANTS

17/ 46 DOUGLAS ST.
MILTON 4064
QUEENSLAND
AUSTRALIA
FAX 62.3858.5699
TEL 617.3858.5688
www.HBAdesign.com

Mfg. Toto (East China)
延安西路 2201号
上海国际贸易中心210室
Shanghai, China
www.toto.com.cn

T +86 21 6270 1010 #161
F +86 21 6270 3099 #161
c Liang Chen 陳良
e chenliang@toto.com.cn

Rep. Toto (East China)
延安西路 2201号
上海国际贸易中心210室
Shanghai, China
www.toto.com.cn

T +86 21 6270 1010 #161
F +86 21 6270 3099 #161
c Liang Chen 陳良
e chenliang@toto.com.cn

MUST BE OF CONTRACT QUALITY AND SUITABLE FOR COMMERCIAL
USE. FABRICATION TO BE IN ACCORDANCE WITH HBA PREAMBLES
(www.hbadesign.com/preambles.html) AND AS FOLLOWS:

1. Description描述: Vanity Basin.
2. Location: Master Bathroom & Powder Room. Refer to Plans and Elevations for exact locations and quantities.
位置: 主人浴室&化妝間. 確切安裝位置及數量請參閱平面及立面圖.
3. Refer to BHX-301 for details.
有关设计概念, 参阅BHX-301.
4. Model模型: PJS02.
5. Dimensions尺寸: 600mm W x 400mm D x 120mm H.
6. Finish材質: White.
7. Manufacturer to submit sample to HBA for approval prior to production.
制造前, 制造商必须呈交样板给于 H B A 批准。
8. Shipping: Must be sufficiently crated/packed/ taped to prevent any damage or breakages.
运输: 必须恰当的箱起/包扎/粘起以防任何的破裂。
9. Must be contract quality and suitable for commercial use.
必须是符合合约的水准并适合商业用途。
10. All item quantites are to be confirmed by operator on site prior to construction.
制造商必须於動工前确认所有数量的需求。
11. All custom designed materials must be coordinated and confirmed by HBA prior to fabrication by contractor.
任何訂製材料務必在承包商製作前與 HBA 協調及最後設計確認。

Issued: 17-Dec-10

Project

Crowne Plaza He Fei

Area:

Presidential Suite Sanitary

Item:

Vanity Basin

Project

5908

Qty.

2 Each

Item
No.

BH-301



HBA

HIRSCH/BEDNER
ASSOCIATES
DESIGN CONSULTANTS

17/ 46 DOUGLAS ST.
MILTON 4064
QUEENSLAND
AUSTRALIA
FAX 62.3858.5699
■ TEL 617.3858.5688 ■
www.HBAdesign.com



Issued: 17-Dec-10

Project

Crowne Plaza He Fei

Area:

Presidential Suite Sanitary

Item:

Vanity Basin

Project	5908
Scale	NTS
By	TK
Item No.	BHX-301



HBA

HIRSCH/BEDNER
ASSOCIATES
DESIGN CONSULTANTS

17/ 46 DOUGLAS ST.
MILTON 4064
QUEENSLAND
AUSTRALIA
FAX 62.3858.5699
■ TEL 617.3858.5688 ■
www.HBAdesign.com

PJS02 桌上式洗脸盆

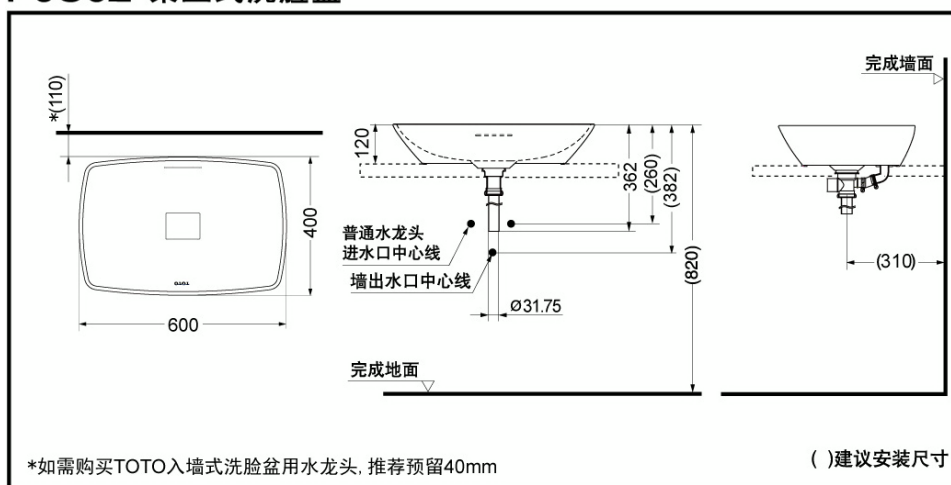

*TOTO公司保留对其产品规格和尺寸更改的权利。届时, 恕不另行通知。

Project

Crowne Plaza He Fei

Area:

Presidential Suite Sanitary

Item:

Vanity Basin

Issued: 17-Dec-10

Project	5908
Scale	NTS
By	TK
Item No.	BHX-301

SPECIFICATION



HBA

HIRSCH/BEDNER
ASSOCIATES
DESIGN CONSULTANTS

17/ 46 DOUGLAS ST.
MILTON 4064
QUEENSLAND
AUSTRALIA
FAX 62.3858.5699
TEL 617.3858.5688
www.HBAdesign.com

Mfg.	Kohler (Asia Pacific Limited) Suite 3312-13, Tower One Time Square, 1 Matheson Street Causeway Bay Hong Kong, Hong Kong www.kohler.com.cn	T	+852 2802 2183
		F	+852 2802 2162
		c	Ken Ho
		e	Ken.Ho@kohler.com
Rep.	Kohler (Asia Pacific Limited) Suite 3312-13, Tower One Time Square, 1 Matheson Street Causeway Bay Hong Kong, Hong Kong www.kohler.com.cn	T	+852 2802 2183
		F	+852 2802 2162
		c	Ken Ho
		e	Ken.Ho@kohler.com

MUST BE OF CONTRACT QUALITY AND SUITABLE FOR COMMERCIAL USE. FABRICATION TO BE IN ACCORDANCE WITH HBA PREAMBLES (www.hbadesign.com/preambles.html) AND AS FOLLOWS:

1. Description描述: Kitchen Sink.
2. Location: Kitchen. Refer to Plans and Elevations for exact locations and quantities.
位置: 廚房. 確切安裝位置及數量請參閱平面及立面圖.
3. Refer to BHX-302 for details.
有关设计概念, 参阅BHX-302.
4. Model模型: K-3748T.
5. Dimensions尺寸: 860mm W x 428mm D x 206mm H.
6. Finish材質: Hairline Stainless Steel.
7. Manufacturer to submit sample to HBA for approval prior to production.
制造前, 制造商必须呈交样板给于HBA批准。
8. Shipping: Must be sufficiently crated/packed/ taped to prevent any damage or breakages.
运输: 必须恰当的箱起/包扎/粘起以防任何的破裂。
9. Must be contract quality and suitable for commercial use.
必须是符合合约的水准并适合商业用途。
10. All item quantites are to be confirmed by operator on site prior to construction.
制造商必须於動工前确认所有数量的需求。
11. All custom designed materials must be coordinated and confirmed by HBA prior to fabrication by contractor.
任何訂製材料務必在承包商製作前與HBA協調及最後設計確認。

Issued: 17-Dec-10

Project

Crowne Plaza He Fei

Area:

Presidential Suite Sanitary

Item:

Kitchen Sink

Project	5908
Qty.	1 Each
Item No.	BH-302



HBA

HIRSCH/BEDNER
ASSOCIATES
DESIGN CONSULTANTS

17/ 46 DOUGLAS ST.
MILTON 4064
QUEENSLAND
AUSTRALIA
FAX 62.3858.5699
■ TEL 617.3858.5688 ■
www.HBAdesign.com

科勒 KOHLER®

奇奥大小槽台上台下双用厨盆

产品尺寸图:(单位:毫米)

GEOG
K-3748T

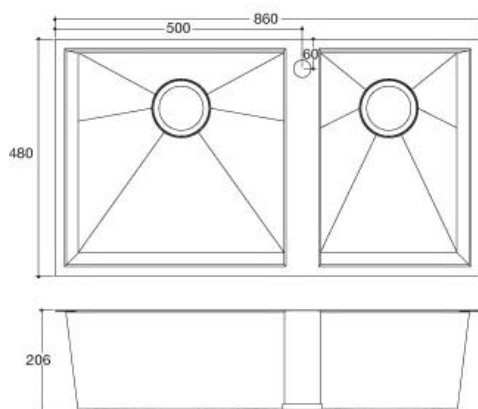

K-3748T

www.kohler.com.cn

Issued: 17-Dec-10

Project

Crowne Plaza He Fei

Area:

Presidential Suite Sanitary

Item:

Kitchen Sink

Project	5908
Scale	NTS
By	TK
Item No.	BHX-302



HBA

HIRSCH/BEDNER
ASSOCIATES
DESIGN CONSULTANTS

17/ 46 DOUGLAS ST.
MILTON 4064
QUEENSLAND
AUSTRALIA
FAX 62.3858.5699
■ TEL 617.3858.5688 ■
www.HBAdesign.com



Issued: 17-Dec-10

Project

Crowne Plaza He Fei

Area:

Presidential Suite Sanitary

Item:

Kitchen Sink

Project	5908
Scale	NTS
By	TK
Item No.	BHX-302

SPECIFICATION



HBA

HIRSCH/BEDNER
ASSOCIATES
DESIGN CONSULTANTS

17/ 46 DOUGLAS ST.
MILTON 4064
QUEENSLAND
AUSTRALIA
FAX 62.3858.5699
TEL 617.3858.5688
www.HBAdesign.com

Mfg. Goldiden Industries Co., Ltd.
江華路采華苑 1 棟 3-4 樓
江門市, 廣東省 529000 China
www.goldiden.com

T +86 75 0316 8222 #68
F +86 75 0316 8737
c Johnny Chen 陈永強
e cyq--168@163.com

Rep. Goldiden Industries Co., Ltd.
江華路采華苑 1 棟 3-4 樓
江門市, 廣東省 529000 China
www.goldiden.com

T +86 75 0316 8222 #68
F +86 75 0316 8737
c Johnny Chen 陈永強
e cyq--168@163.com

MUST BE OF CONTRACT QUALITY AND SUITABLE FOR COMMERCIAL
USE. FABRICATION TO BE IN ACCORDANCE WITH HBA PREAMBLES
(www.hbadesign.com/preambles.html) AND AS FOLLOWS:

1. Description描述: Vanity Mixer.
2. Location: Bathroom. Refer to Plans and Elevations for exact locations and quantities.
位置: 浴室. 確切安裝位置及數量請參閱平面及立面圖.
3. Refer to BHX-303 for details.
有关设计概念, 参阅BHX-303.
4. Model模型: Sea JT016151P11.
5. Dimensions尺寸: 200mm OAW x 163mm OAD x 80mm OAH. As per manufacturer.
6. Finish材質: Polished Chrome.
7. Manufacturer to submit sample to HBA for approval prior to production.
制造前, 制造商必须呈交样板给于HBA批准。
8. Shipping: Must be sufficiently crated/packed/ taped to prevent any damage or breakages.
运输: 必须恰当的箱起/包扎/粘起以防任何的破裂。
9. Must be contract quality and suitable for commercial use.
必须是符合合约的水准并适合商业用途。
10. All item quantites are to be confirmed by operator on site prior to construction.
制造商必须於動工前确认所有数量的需求。
11. All custom designed materials must be coordinated and confirmed by HBA prior to fabrication
by contractor.
任何訂製材料務必在承包商製作前與 HBA 協調及最後設計確認。

Issued: 17-Dec-10

Project

Crowne Plaza He Fei

Area:

Presidential Suite Sanitary

Item:

Vanity Mixer

Project

5908

Qty.

2 Each

Item
No.

BH-303



HBA

HIRSCH/BEDNER
ASSOCIATES
DESIGN CONSULTANTS

17/ 46 DOUGLAS ST.
MILTON 4064
QUEENSLAND
AUSTRALIA
FAX 62.3858.5699
■ TEL 617.3858.5688 ■
www.HBAdesign.com

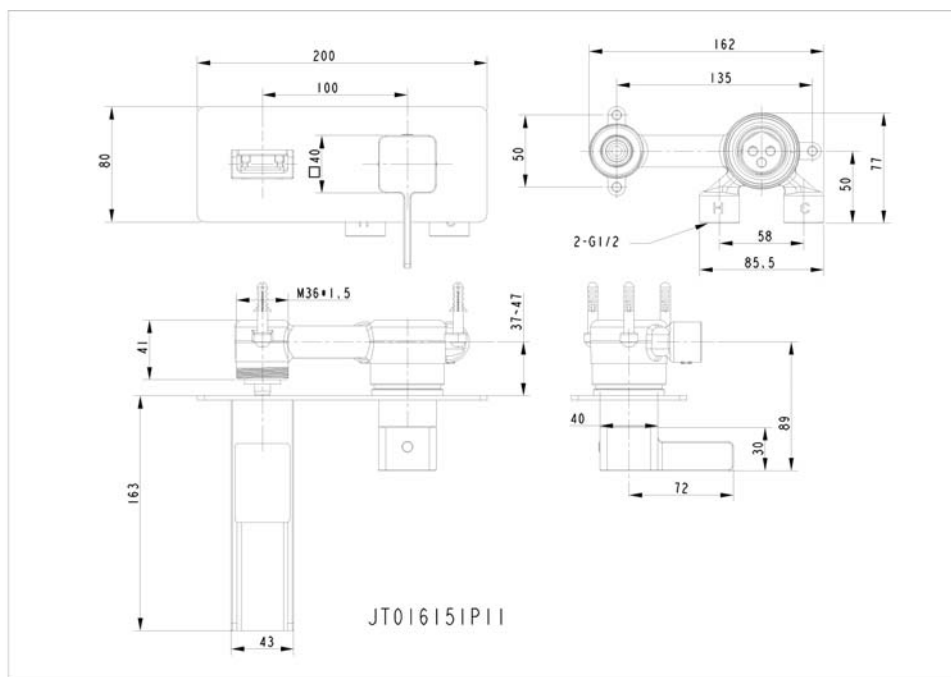

Issued: 17-Dec-10

Project

Crowne Plaza He Fei

Area:

Presidential Suite Sanitary

Item:

Vanity Mixer

Project	5908
Scale	NTS
By	TK
Item No.	BHX-303



HBA

HIRSCH/BEDNER
ASSOCIATES
DESIGN CONSULTANTS

17/ 46 DOUGLAS ST.
MILTON 4064
QUEENSLAND
AUSTRALIA
FAX 62.3858.5699
■ TEL 617.3858.5688 ■
www.HBAdesign.com

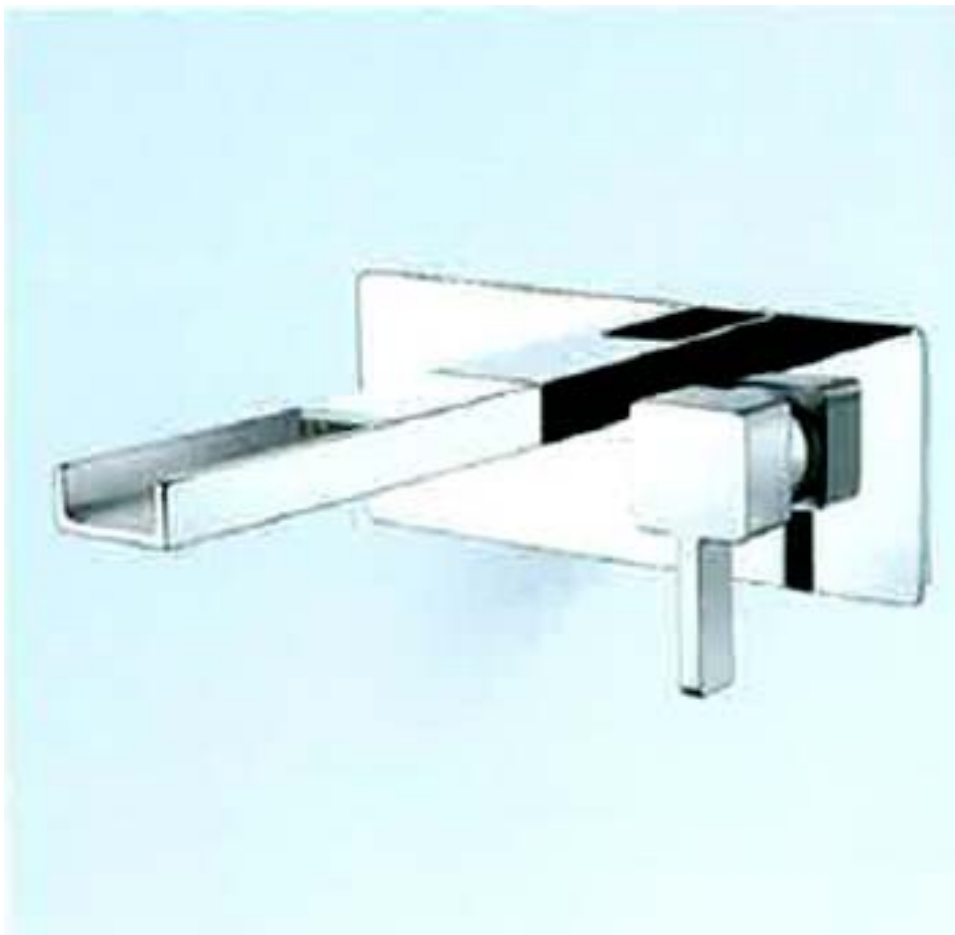

Issued: 17-Dec-10

Project

Crowne Plaza He Fei

Area:

Presidential Suite Sanitary

Item:

Vanity Mixer

Project	5908
Scale	NTS
By	TK
Item No.	BHX-303

SPECIFICATION



HBA

HIRSCH/BEDNER
ASSOCIATES
DESIGN CONSULTANTS

17/ 46 DOUGLAS ST.
MILTON 4064
QUEENSLAND
AUSTRALIA
FAX 62.3858.5699
TEL 617.3858.5688
www.HBAdesign.com

Mfg. Kohler (Asia Pacific Limited)
Suite 3312-13, Tower One
Time Square, 1 Matheson Street
Causeway Bay
Hong Kong, Hong Kong
www.kohler.com.cn

T +852 2802 2183
F +852 2802 2162
c Ken Ho
e Ken.Ho@kohler.com

Rep. Kohler (Asia Pacific Limited)
Suite 3312-13, Tower One
Time Square, 1 Matheson Street
Causeway Bay
Hong Kong, Hong Kong
www.kohler.com.cn

T +852 2802 2183
F +852 2802 2162
c Ken Ho
e Ken.Ho@kohler.com

MUST BE OF CONTRACT QUALITY AND SUITABLE FOR COMMERCIAL
USE. FABRICATION TO BE IN ACCORDANCE WITH HBA PREAMBLES
(www.hbadesign.com/preambles.html) AND AS FOLLOWS:

1. Description描述: Kitchen Sink Mixer.
2. Location: Kitchen. Refer to Plans and Elevations for exact locations and quantities.
位置: 廚房. 確切安裝位置及數量請參閱平面及立面圖.
3. Refer to BHX-304 for details.
有关设计概念, 参阅BHX-304.
4. Model模型: Singulier K-10877T.
5. Dimensions尺寸: As per manufacturer.
6. Finish材質: Polished Chrome.
7. Manufacturer to submit sample to HBA for approval prior to production.
制造前, 制造商必须呈交样板给于HBA批准。
8. Shipping: Must be sufficiently crated/packed/ taped to prevent any damage or breakages.
运输: 必须恰当的箱起/包扎/粘起以防任何的破裂。
9. Must be contract quality and suitable for commercial use.
必须是符合合约的水准并适合商业用途。
10. All item quantites are to be confirmed by operator on site prior to construction.
制造商必须於動工前确认所有数量的需求。
11. All custom designed materials must be coordinated and confirmed by HBA prior to fabrication
by contractor.
任何訂製材料務必在承包商製作前與HBA協調及最後設計確認。

Issued: 17-Dec-10

Project

Crowne Plaza He Fei

Area:

Presidential Suite Sanitary

Item:

Kitchen Sink Mixer

Project

5908

Qty.

1 Each

Item
No.

BH-304



HBA

HIRSCH/BEDNER
ASSOCIATES
DESIGN CONSULTANTS

17/ 46 DOUGLAS ST.
MILTON 4064
QUEENSLAND
AUSTRALIA
FAX 62.3858.5699
■ TEL 617.3858.5688 ■
www.HBAdesign.com

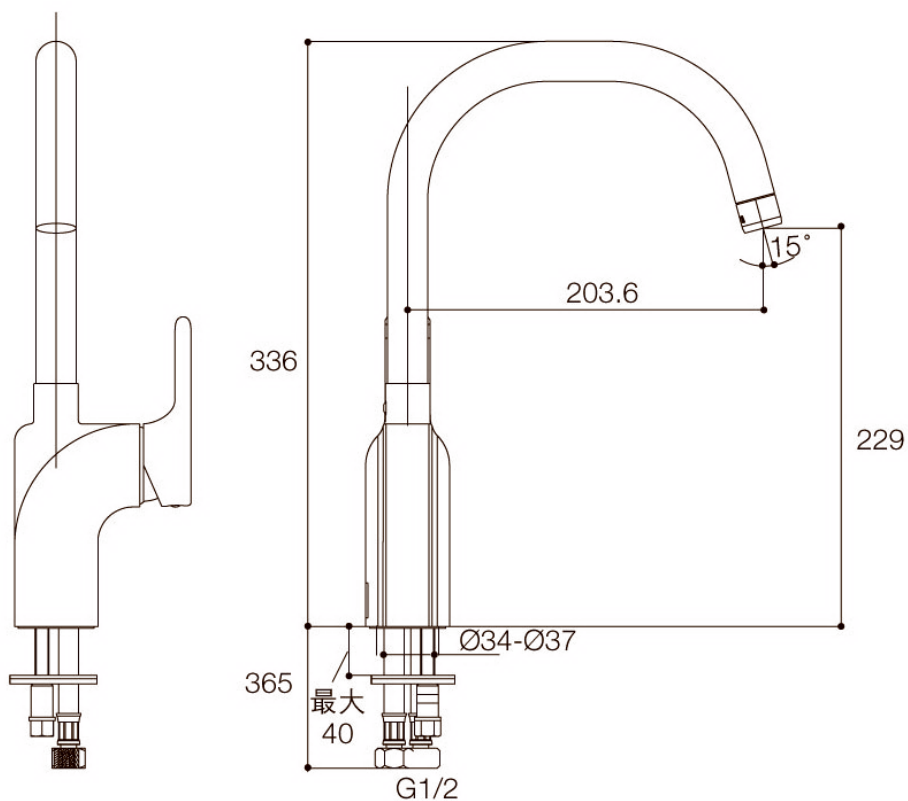

K-10877T

Issued: 17-Dec-10

Project

Crowne Plaza He Fei

Area:

Presidential Suite Sanitary

Item:

Kitchen Sink Mixer

Project	5908
Scale	NTS
By	TK
Item No.	BHX-304



HBA

HIRSCH/BEDNER
ASSOCIATES
DESIGN CONSULTANTS

17/ 46 DOUGLAS ST.
MILTON 4064
QUEENSLAND
AUSTRALIA
FAX 62.3858.5699
■ TEL 617.3858.5688 ■
www.HBAdesign.com



Issued: 17-Dec-10

Project

Crowne Plaza He Fei

Area:

Presidential Suite Sanitary

Item:

Kitchen Sink Mixer

Project	5908
Scale	NTS
By	TK
Item No.	BHX-304

SPECIFICATION



HBA

HIRSCH/BEDNER
ASSOCIATES
DESIGN CONSULTANTS

17/ 46 DOUGLAS ST.
MILTON 4064
QUEENSLAND
AUSTRALIA
FAX 62.3858.5699
TEL 617.3858.5688
www.HBAdesign.com

Mfg. Toto (East China)
延安西路 2201号
上海国际贸易中心210室
Shanghai, China
www.toto.com.cn

T +86 21 6270 1010 #161
F +86 21 6270 3099 #161
c Liang Chen 陳良
e chenliang@toto.com.cn

Rep. Toto (East China)
延安西路 2201号
上海国际贸易中心210室
Shanghai, China
www.toto.com.cn

T +86 21 6270 1010 #161
F +86 21 6270 3099 #161
c Liang Chen 陳良
e chenliang@toto.com.cn

MUST BE OF CONTRACT QUALITY AND SUITABLE FOR COMMERCIAL
USE. FABRICATION TO BE IN ACCORDANCE WITH HBA PREAMBLES
(www.hbadesign.com/preambles.html) AND AS FOLLOWS:

1. Description描述: Bottle Trap.
2. Location: Master Bathroom & Powder Room. Refer to Plans and Elevations for exact locations and quantities.
位置: 主人浴室&化妝間. 確切安裝位置及數量請參閱平面及立面圖.
3. Refer to BHX-305 for details.
有关设计概念, 参阅BHX-305.
4. Model模型: DL501B.
5. Dimensions尺寸: As per manufacturer.
6. Finish材質: Polished Chrome.
7. Manufacturer to submit sample to HBA for approval prior to production.
制造前, 制造商必须呈交样板给于HBA批准。
8. Shipping: Must be sufficiently crated/packed/ taped to prevent any damage or breakages.
运输: 必须恰当的箱起/包扎/粘起以防任何的破裂。
9. Must be contract quality and suitable for commercial use.
必须是符合合约的水准并适合商业用途。
10. All item quantities are to be confirmed by operator on site prior to construction.
制造商必须於動工前确认所有数量的需求。
11. All custom designed materials must be coordinated and confirmed by HBA prior to fabrication by contractor.
任何訂製材料務必在承包商製作前與HBA協調及最後設計確認。

Issued: 17-Dec-10

Project

Crowne Plaza He Fei

Area:

Presidential Suite Sanitary

Item:

Bottle Trap

Project

5908

Qty.

4 Each

Item
No.

BH-305



HBA

HIRSCH/BEDNER
ASSOCIATES
DESIGN CONSULTANTS

17/ 46 DOUGLAS ST.
MILTON 4064
QUEENSLAND
AUSTRALIA
FAX 62.3858.5699
■ TEL 617.3858.5688 ■
www.HBAdesign.com

DL501B 洗脸盆用存水弯

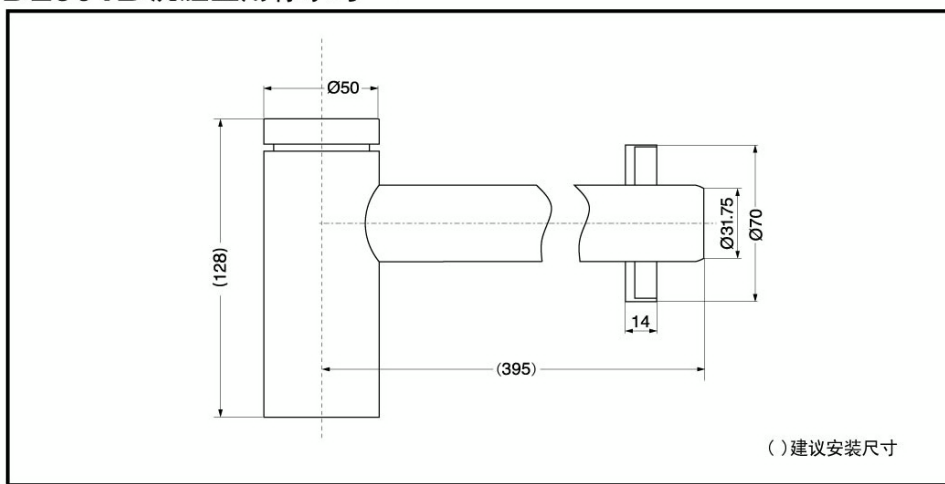

*TOTO公司保留对其产品规格和尺寸更改的权利。届时，恕不另行通知。

Issued: 17-Dec-10

Project

Crowne Plaza He Fei

Area:

Presidential Suite Sanitary

Item:

Bottle Trap

Project	5908
Scale	NTS
By	TK
Item No.	BHX-305

SPECIFICATION



HBA

HIRSCH/BEDNER
ASSOCIATES
DESIGN CONSULTANTS

17/ 46 DOUGLAS ST.
MILTON 4064
QUEENSLAND
AUSTRALIA
FAX 62.3858.5699
■ TEL 617.3858.5688 ■
www.HBAdesign.com

MUST BE OF CONTRACT QUALITY AND SUITABLE FOR COMMERCIAL
USE. FABRICATION TO BE IN ACCORDANCE WITH HBA PREAMBLES
(www.hbadesign.com/preambles.html) AND AS FOLLOWS:

Project

Crowne Plaza He Fei

Area:

Presidential Suite Sanitary

Item:

...Open...

Issued: 17-Dec-10

Project	5908
Qty.	
Item No.	BH-306

SPECIFICATION



HBA

HIRSCH/BEDNER
ASSOCIATES
DESIGN CONSULTANTS

17/ 46 DOUGLAS ST.
MILTON 4064
QUEENSLAND
AUSTRALIA
FAX 62.3858.5699
■ TEL 617.3858.5688 ■
www.HBAdesign.com

MUST BE OF CONTRACT QUALITY AND SUITABLE FOR COMMERCIAL
USE. FABRICATION TO BE IN ACCORDANCE WITH HBA PREAMBLES
(www.hbadesign.com/preambles.html) AND AS FOLLOWS:

Project

Crowne Plaza He Fei

Area:

Presidential Suite Sanitary

Item:

...Open...

Issued: 17-Dec-10

Project	5908
Qty.	
Item No.	BH-307

SPECIFICATION



HBA

HIRSCH/BEDNER
ASSOCIATES
DESIGN CONSULTANTS

17/ 46 DOUGLAS ST.
MILTON 4064
QUEENSLAND
AUSTRALIA
FAX 62.3858.5699
TEL 617.3858.5688
www.HBAdesign.com

Mfg. Toto (East China)
延安西路 2201号
上海国际贸易中心210室
Shanghai, China
www.toto.com.cn

T +86 21 6270 1010 #161
F +86 21 6270 3099 #161
c Liang Chen 陳良
e chenliang@toto.com.cn

Rep. Toto (East China)
延安西路 2201号
上海国际贸易中心210室
Shanghai, China
www.toto.com.cn

T +86 21 6270 1010 #161
F +86 21 6270 3099 #161
c Liang Chen 陳良
e chenliang@toto.com.cn

MUST BE OF CONTRACT QUALITY AND SUITABLE FOR COMMERCIAL
USE. FABRICATION TO BE IN ACCORDANCE WITH HBA PREAMBLES
(www.hbadesign.com/preambles.html) AND AS FOLLOWS:

1. Description描述: Water Closet.
2. Location: Master Bathroom & Powder Room. Refer to Plans and Elevations for exact locations and quantities.
位置: 主人浴室&化妝間. 確切安裝位置及數量請參閱平面及立面圖.
3. Refer to BHX-308 for details.
有关设计概念, 参阅BHX-308.
4. Model模型: CW981NB.
5. Dimensions尺寸: As per manufacturer.
6. Finish材質: White.
7. Manufacturer to submit sample to HBA for approval prior to production.
制造前, 制造商必须呈交样板给于HBA批准。
8. Shipping: Must be sufficiently crated/packed/ taped to prevent any damage or breakages.
运输: 必须恰当的箱起/包扎/粘起以防任何的破裂。
9. Must be contract quality and suitable for commercial use.
必须是符合合约的水准并适合商业用途。
10. All item quantites are to be confirmed by operator on site prior to construction.
制造商必须於動工前确认所有数量的需求。
11. All custom designed materials must be coordinated and confirmed by HBA prior to fabrication by contractor.
任何訂製材料務必在承包商製作前與HBA協調及最後設計確認。

Issued: 17-Dec-10

Project

Crowne Plaza He Fei

Area:

Presidential Suite Sanitary

Item:

Water Closet

Project

5908

Qty.

2 Each

Item
No.

BH-308

TOTO

分体坐便器

型号

CW981NB/SW981B



HBA

HIRSCH/BEDNER
ASSOCIATES
DESIGN CONSULTANTS

17/ 46 DOUGLAS ST.
MILTON 4064
QUEENSLAND
AUSTRALIA
FAX 62.3858.5699
■ TEL 617.3858.5688 ■
www.HBAdesign.com

产品介绍:

CW981NB/SW981B (坑距305mm)

分体式坐便器 (加长型)

700×390×773mm

3/6L大小切换

智洁

太平洋系列

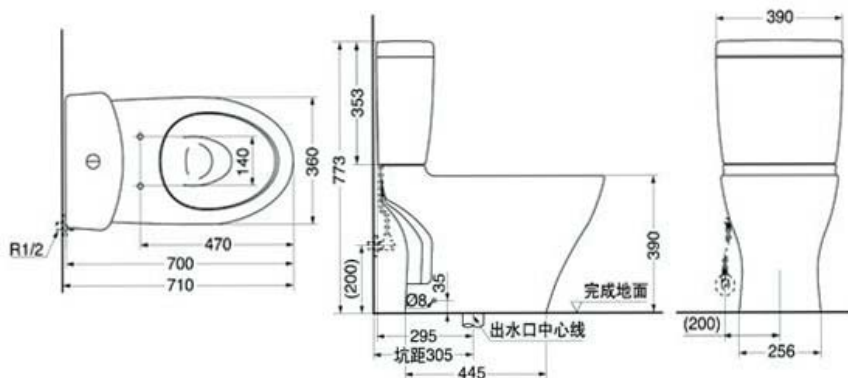

() 建议安装尺寸

*TOTO公司保留对其产品规格和尺寸更改的权利, 届时, 恕不另行通知

Issued: 17-Dec-10

Project

Crowne Plaza He Fei

Area:

Presidential Suite Sanitary

Item:

Water Closet

Project	5908
Scale	NTS
By	TK
Item No.	BHX-308

SPECIFICATION



HBA

HIRSCH/BEDNER
ASSOCIATES
DESIGN CONSULTANTS

17/ 46 DOUGLAS ST.
MILTON 4064
QUEENSLAND
AUSTRALIA
FAX 62.3858.5699
TEL 617.3858.5688
www.HBAdesign.com

Mfg. Toto (East China)
延安西路 2201号
上海国际贸易中心210室
Shanghai, China
www.toto.com.cn

T +86 21 6270 1010 #161
F +86 21 6270 3099 #161
c Liang Chen 陳良
e chenliang@toto.com.cn

Rep. Toto (East China)
延安西路 2201号
上海国际贸易中心210室
Shanghai, China
www.toto.com.cn

T +86 21 6270 1010 #161
F +86 21 6270 3099 #161
c Liang Chen 陳良
e chenliang@toto.com.cn

MUST BE OF CONTRACT QUALITY AND SUITABLE FOR COMMERCIAL
USE. FABRICATION TO BE IN ACCORDANCE WITH HBA PREAMBLES
(www.hbadesign.com/preambles.html) AND AS FOLLOWS:

1. Description描述: Bidet.
2. Location: Master Bathroom. Refer to Plans and Elevations for exact locations and quantities.
位置: 主人浴室. 確切安裝位置及數量請參閱平面及立面圖.
3. Refer to BHX-309 for details.
有关设计概念, 参阅BHX-309.
4. Model模型: BW986B.
5. Dimensions尺寸: As per manufacturer.
6. Finish材質: White.
7. Manufacturer to submit sample to HBA for approval prior to production.
制造前, 制造商必须呈交样板给于HBA批准。
8. Shipping: Must be sufficiently crated/packed/ taped to prevent any damage or breakages.
运输: 必须恰当的箱起/包扎/粘起以防任何的破裂。
9. Must be contract quality and suitable for commercial use.
必须是符合合约的水准并适合商业用途。
10. All item quantities are to be confirmed by operator on site prior to construction.
制造商必须於動工前确认所有数量的需求。
11. All custom designed materials must be coordinated and confirmed by HBA prior to fabrication
by contractor.
任何訂製材料務必在承包商製作前與HBA協調及最後設計確認。

Issued: 17-Dec-10

Project

Crowne Plaza He Fei

Area:

Presidential Suite Sanitary

Item:

Bidet

Project	5908
Qty.	1 Each
Item No.	BH-309



HBA

HIRSCH/BEDNER
ASSOCIATES
DESIGN CONSULTANTS

17/ 46 DOUGLAS ST.
MILTON 4064
QUEENSLAND
AUSTRALIA
FAX 62.3858.5699
■ TEL 617.3858.5688 ■
www.HBAdesign.com



Issued: 17-Dec-10

Project

Crowne Plaza He Fei

Area:

Presidential Suite Sanitary

Item:

Bidet

Project	5908
Scale	NTS
By	TK
Item No.	BHX-309



HBA

HIRSCH/BEDNER
ASSOCIATES
DESIGN CONSULTANTS

17/ 46 DOUGLAS ST.
MILTON 4064
QUEENSLAND
AUSTRALIA
FAX 62.3858.5699
■ TEL 617.3858.5688 ■
www.HBAdesign.com

BW986B 净身盆 (Le Blanc系列)

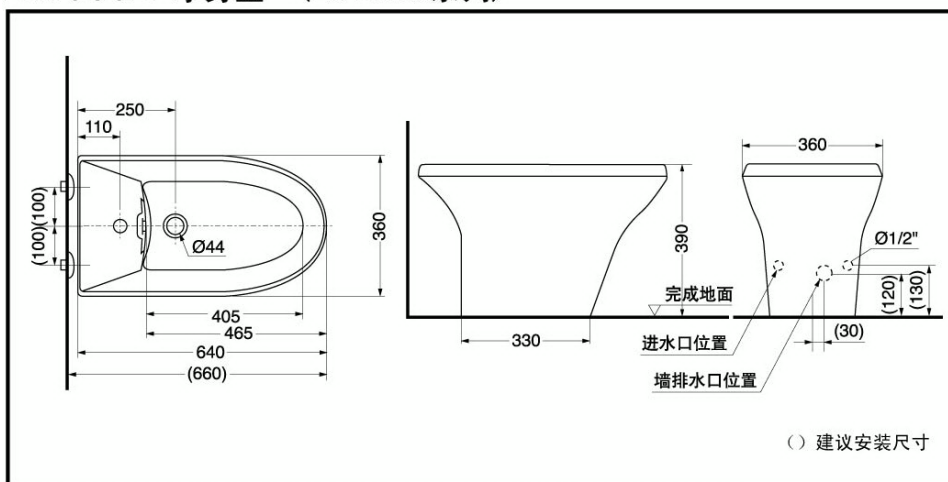

*TOTO公司保留对其产品规格和尺寸更改的权利。届时，恕不另行通知。

Issued: 17-Dec-10

Project

Crowne Plaza He Fei

Area:

Presidential Suite Sanitary

Item:

Bidet

Project	5908
Scale	NTS
By	TK
Item No.	BHX-309

SPECIFICATION



HBA

HIRSCH/BEDNER
ASSOCIATES
DESIGN CONSULTANTS

17/ 46 DOUGLAS ST.
MILTON 4064
QUEENSLAND
AUSTRALIA
FAX 62.3858.5699
TEL 617.3858.5688
www.HBAdesign.com

Mfg. Goldiden Industries Co., Ltd.
江華路采華苑 1 棟 3-4 樓
江門市, 廣東省 529000 China
www.goldiden.com

T +86 75 0316 8222 #68
F +86 75 0316 8737
c Johnny Chen 陈永強
e cyq--168@163.com

Rep. Goldiden Industries Co., Ltd.
江華路采華苑 1 棟 3-4 樓
江門市, 廣東省 529000 China
www.goldiden.com

T +86 75 0316 8222 #68
F +86 75 0316 8737
c Johnny Chen 陈永強
e cyq--168@163.com

MUST BE OF CONTRACT QUALITY AND SUITABLE FOR COMMERCIAL
USE. FABRICATION TO BE IN ACCORDANCE WITH HBA PREAMBLES
(www.hbadesign.com/preambles.html) AND AS FOLLOWS:

1. Description描述: Bidet Mixer.
2. Location: Master Bathroom. Refer to Plans and Elevations for exact locations and quantities.
位置: 主人浴室. 確切安裝位置及數量請參閱平面及立面圖.
3. Refer to BHX-310 for details.
有关设计概念, 参阅BHX-310.
4. Model模型: Sea JT016260P11.
5. Dimensions尺寸: As per manufacturer.
6. Finish材質: Polished Chrome.
7. Manufacturer to submit sample to HBA for approval prior to production.
制造前, 制造商必须呈交样板给于HBA批准。
8. Shipping: Must be sufficiently crated/packed/ taped to prevent any damage or breakages.
运输: 必须恰当的箱起/包扎/粘起以防任何的破裂。
9. Must be contract quality and suitable for commercial use.
必须是符合合约的水准并适合商业用途。
10. All item quantites are to be confirmed by operator on site prior to construction.
制造商必须於動工前确认所有数量的需求。
11. All custom designed materials must be coordinated and confirmed by HBA prior to fabrication
by contractor.
任何訂製材料務必在承包商製作前與 HBA 協調及最後設計確認。

Issued: 17-Dec-10

Project

Crowne Plaza He Fei

Area:

Presidential Suite Sanitary

Item:

Bidet Mixer

Project

5908

Qty.

1 Each

Item
No.

BH-310



HBA

HIRSCH/BEDNER
ASSOCIATES
DESIGN CONSULTANTS

17/ 46 DOUGLAS ST.
MILTON 4064
QUEENSLAND
AUSTRALIA
FAX 62.3858.5699
■ TEL 617.3858.5688 ■
www.HBAdesign.com

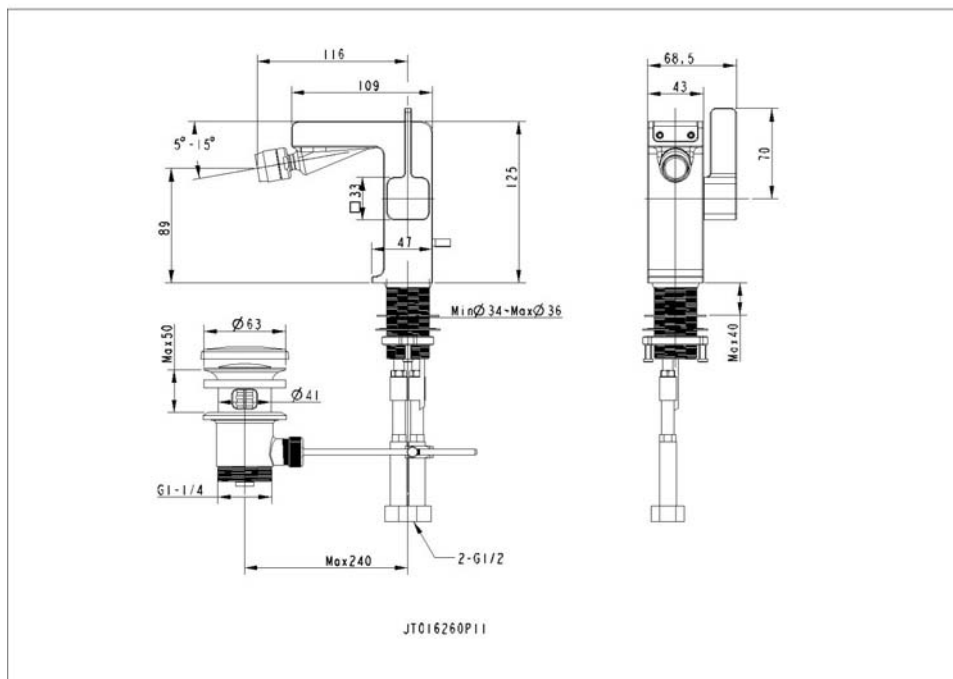

Issued: 17-Dec-10

Project

Crowne Plaza He Fei

Area:

Presidential Suite Sanitary

Item:

Bidet Mixer

Project	5908
Scale	NTS
By	TK
Item No.	BHX-310



HBA

HIRSCH/BEDNER
ASSOCIATES
DESIGN CONSULTANTS

17/ 46 DOUGLAS ST.
MILTON 4064
QUEENSLAND
AUSTRALIA
FAX 62.3858.5699
■ TEL 617.3858.5688 ■
www.HBAdesign.com



Issued: 17-Dec-10

Project

Crowne Plaza He Fei

Area:

Presidential Suite Sanitary

Item:

Bidet Mixer

Project	5908
Scale	NTS
By	TK
Item No.	BHX-310

SPECIFICATION



HBA

HIRSCH/BEDNER
ASSOCIATES
DESIGN CONSULTANTS

17/ 46 DOUGLAS ST.
MILTON 4064
QUEENSLAND
AUSTRALIA
FAX 62.3858.5699
TEL 617.3858.5688
www.HBAdesign.com

Mfg. Toto (East China)
延安西路 2201号
上海国际贸易中心210室
Shanghai, China
www.toto.com.cn

T +86 21 6270 1010 #161
F +86 21 6270 3099 #161
c Liang Chen 陳良
e chenliang@toto.com.cn

Rep. Toto (East China)
延安西路 2201号
上海国际贸易中心210室
Shanghai, China
www.toto.com.cn

T +86 21 6270 1010 #161
F +86 21 6270 3099 #161
c Liang Chen 陳良
e chenliang@toto.com.cn

MUST BE OF CONTRACT QUALITY AND SUITABLE FOR COMMERCIAL
USE. FABRICATION TO BE IN ACCORDANCE WITH HBA PREAMBLES
(www.hbadesign.com/preambles.html) AND AS FOLLOWS:

1. Description描述: Bathtub III.
2. Location: Master Bathroom. Refer to Plans and Elevations for exact locations and quantities.
位置: 主人浴室. 確切安裝位置及數量請參閱平面及立面圖.
3. Refer to BHX-311 for details.
有关设计概念, 参阅BHX-311.
4. Model模型: PPY1724HPW.
5. Dimensions尺寸: 1700mm DIA x 600mm H.
6. Finish材質: White.
7. Manufacturer to submit sample to HBA for approval prior to production.
制造前, 制造商必须呈交样板给于HBA批准。
8. Shipping: Must be sufficiently crated/packed/ taped to prevent any damage or breakages.
运输: 必须恰当的箱起/包扎/粘起以防任何的破裂。
9. Must be contract quality and suitable for commercial use.
必须是符合合约的水准并适合商业用途。
10. All item quantites are to be confirmed by operator on site prior to construction.
制造商必须於動工前确认所有数量的需求。
11. All custom designed materials must be coordinated and confirmed by HBA prior to fabrication
by contractor.
任何訂製材料務必在承包商製作前與HBA協調及最後設計確認。

Issued: 17-Dec-10

Project

Crowne Plaza He Fei

Area:

Presidential Suite Sanitary

Item:

Bathtub III

Project

5908

Qty.

1 Each

Item
No.

BH-311



HBA

HIRSCH/BEDNER
ASSOCIATES
DESIGN CONSULTANTS

17/ 46 DOUGLAS ST.
MILTON 4064
QUEENSLAND
AUSTRALIA
FAX 62.3858.5699
TEL 617.3858.5688
www.HBAdesign.com



PPY1724HPW#F
PPY1724PW#F 珠光浴缸 有裙边

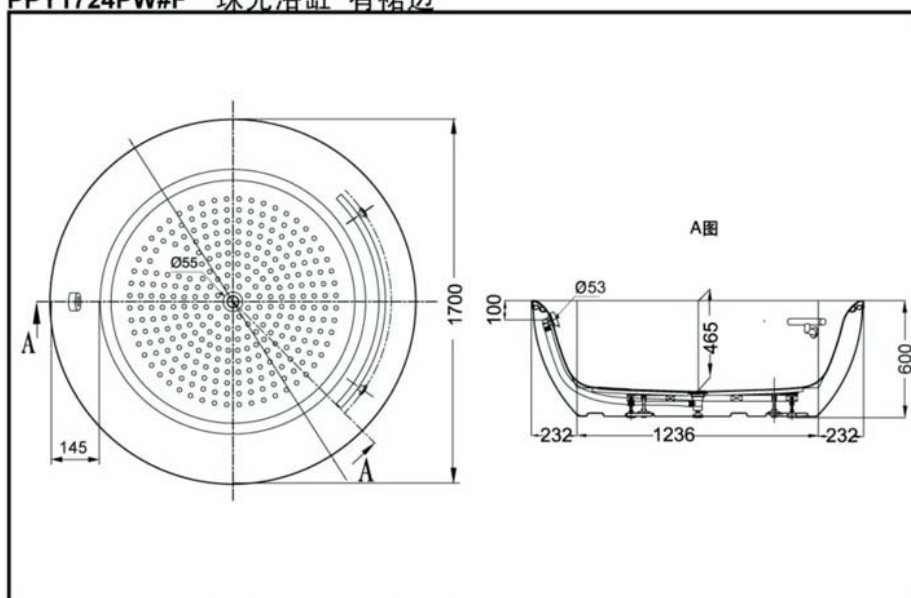

*TOTO公司保留对其产品规格和尺寸更改的权利。届时，恕不另行通知。

Issued: 17-Dec-10

Project

Crowne Plaza He Fei

Area:

Presidential Suite Sanitary

Item:

Bathtub III

Project	5908
Scale	NTS
By	TK
Item No.	BHX-311

SPECIFICATION



HBA

HIRSCH/BEDNER
ASSOCIATES
DESIGN CONSULTANTS

17/ 46 DOUGLAS ST.
MILTON 4064
QUEENSLAND
AUSTRALIA
FAX 62.3858.5699
TEL 617.3858.5688
www.HBAdesign.com

Mfg. Goldiden Industries Co., Ltd.
江華路采華苑 1 棟 3-4 樓
江門市, 廣東省 529000 China
www.goldiden.com

T +86 75 0316 8222 #68
F +86 75 0316 8737
c Johnny Chen 陈永強
e cyq--168@163.com

Rep. Goldiden Industries Co., Ltd.
江華路采華苑 1 棟 3-4 樓
江門市, 廣東省 529000 China
www.goldiden.com

T +86 75 0316 8222 #68
F +86 75 0316 8737
c Johnny Chen 陈永強
e cyq--168@163.com

MUST BE OF CONTRACT QUALITY AND SUITABLE FOR COMMERCIAL
USE. FABRICATION TO BE IN ACCORDANCE WITH HBA PREAMBLES
(www.hbadesign.com/preambles.html) AND AS FOLLOWS:

1. Description描述: Bathtub Mixer Set II.
2. Location: Master Bathroom. Refer to Plans and Elevations for exact locations and quantities.
位置: 主人浴室. 確切安裝位置及數量請參閱平面及立面圖.
3. Refer to BHX-312 for details.
有关设计概念, 参阅BHX-312.
4. Model模型: JT016342P11.
5. Dimensions尺寸: As per manufacturer.
6. Finish材質: Polished Chrome.
7. Manufacturer to submit sample to HBA for approval prior to production.
制造前, 制造商必须呈交样板给于HBA批准。
8. Shipping: Must be sufficiently crated/packed/ taped to prevent any damage or breakages.
运输: 必须恰当的箱起/包扎/粘起以防任何的破裂。
9. Must be contract quality and suitable for commercial use.
必须是符合合约的水准并适合商业用途。
10. All item quantities are to be confirmed by operator on site prior to construction.
制造商必须於動工前确认所有数量的需求。
11. All custom designed materials must be coordinated and confirmed by HBA prior to fabrication
by contractor.
任何訂製材料務必在承包商製作前與 HBA 協調及最後設計確認。

Issued: 17-Dec-10

Project

Crowne Plaza He Fei

Area:

Presidential Suite Sanitary

Item:

Bathtub Mixer Set II

Project

5908

Qty.

1 Set

Item
No.

BH-312



HBA

HIRSCH/BEDNER
ASSOCIATES
DESIGN CONSULTANTS

17/ 46 DOUGLAS ST.
MILTON 4064
QUEENSLAND
AUSTRALIA
FAX 62.3858.5699
■ TEL 617.3858.5688 ■
www.HBAdesign.com

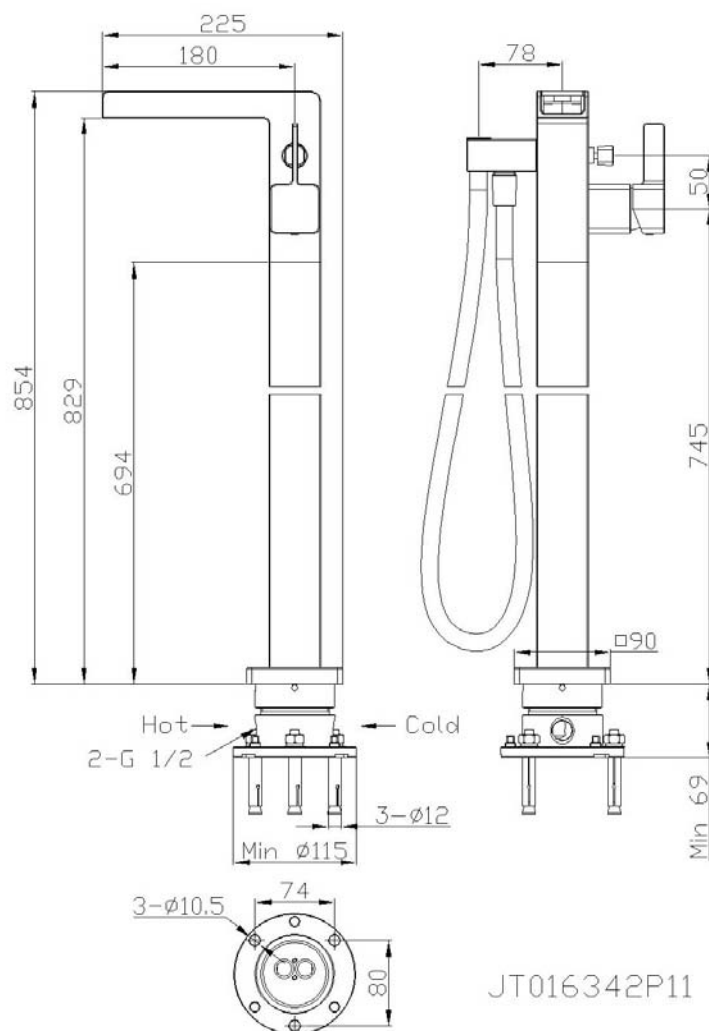

Project

Crowne Plaza He Fei

Area:

Presidential Suite Sanitary

Item:

Bathtub Mixer Set II

Issued: 17-Dec-10

Project	5908
Scale	NTS
By	TK
Item No.	BHX-312



HBA

HIRSCH/BEDNER
ASSOCIATES
DESIGN CONSULTANTS

17/ 46 DOUGLAS ST.
MILTON 4064
QUEENSLAND
AUSTRALIA
FAX 62.3858.5699
■ TEL 617.3858.5688 ■
www.HBAdesign.com

Issued: 17-Dec-10

Project

Crowne Plaza He Fei

Area:

Presidential Suite Sanitary

Item:

Bathtub Mixer Set II

Project	5908
Scale	NTS
By	TK
Item No.	BHX-312

SPECIFICATION



HBA

HIRSCH/BEDNER
ASSOCIATES
DESIGN CONSULTANTS

17/ 46 DOUGLAS ST.
MILTON 4064
QUEENSLAND
AUSTRALIA
FAX 62.3858.5699
TEL 617.3858.5688
www.HBAdesign.com

Mfg. Goldiden Industries Co., Ltd.
江華路采華苑 1 棟 3-4 樓
江門市, 廣東省 529000 China
www.goldiden.com

T +86 75 0316 8222 #68
F +86 75 0316 8737
c Johnny Chen 陈永強
e cyq--168@163.com

Rep. Goldiden Industries Co., Ltd.
江華路采華苑 1 棟 3-4 樓
江門市, 廣東省 529000 China
www.goldiden.com

T +86 75 0316 8222 #68
F +86 75 0316 8737
c Johnny Chen 陈永強
e cyq--168@163.com

MUST BE OF CONTRACT QUALITY AND SUITABLE FOR COMMERCIAL
USE. FABRICATION TO BE IN ACCORDANCE WITH HBA PREAMBLES
(www.hbadesign.com/preambles.html) AND AS FOLLOWS:

1. Description描述: Shower Set.
2. Location: Master Bathroom. Refer to Plans and Elevations for exact locations and quantities.
位置: 主人浴室. 確切安裝位置及數量請參閱平面及立面圖.
3. Refer to BHX-313 for details.
有关设计概念, 参阅BHX-313.
4. Model模型: JT016373P11 - JC030313P11 & JT016327P11 & JT000795P11 & JC030110P11.
5. Dimensions尺寸: As per manufacturer.
6. Finish材質: Polished Chrome.
7. Manufacturer to submit sample to HBA for approval prior to production.
制造前, 制造商必须呈交样板给于H B A批准。
8. Shipping: Must be sufficiently crated/packed/ taped to prevent any damage or breakages.
运输: 必须恰当的箱起/包扎/粘起以防任何的破裂。
9. Must be contract quality and suitable for commercial use.
必须是符合合约的水准并适合商业用途。
10. All item quantites are to be confirmed by operator on site prior to construction.
制造商必须於動工前确认所有数量的需求。
11. All custom designed materials must be coordinated and confirmed by HBA prior to fabrication
by contractor.
任何訂製材料務必在承包商製作前與 HBA 協調及最後設計確認。

Issued: 17-Dec-10

Project

Crowne Plaza He Fei

Area:

Presidential Suite Sanitary

Item:

Shower Set

Project

5908

Qty.

1 Set

Item
No.

BH-313

HBA

HIRSCH/BEDNER
ASSOCIATES
DESIGN CONSULTANTS

17/ 46 DOUGLAS ST.
MILTON 4064
QUEENSLAND
AUSTRALIA
FAX 62.3858.5699
■ TEL 617.3858.5688 ■
www.HBAdesign.com

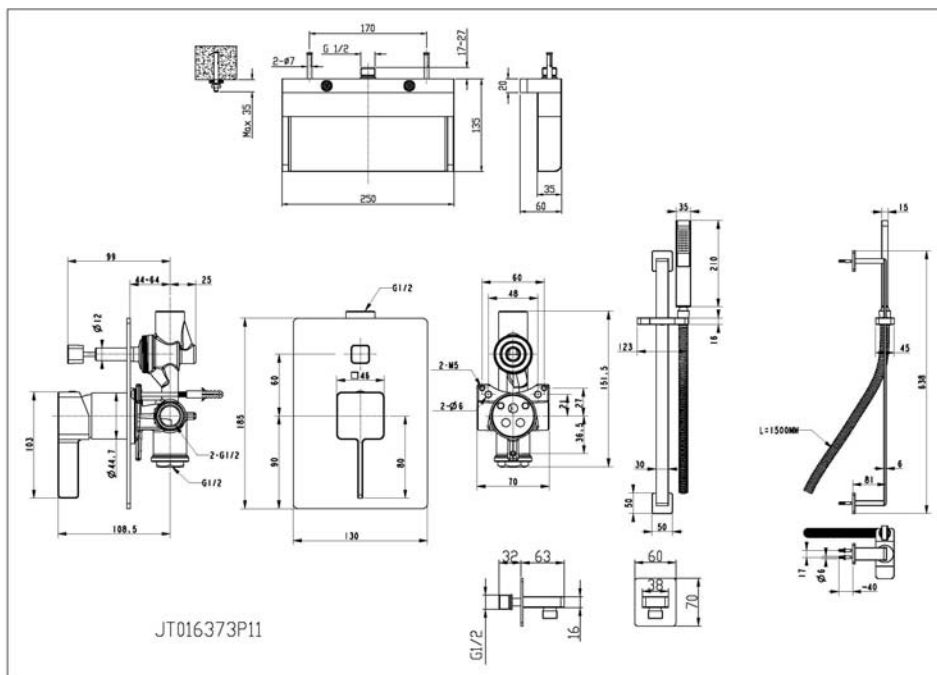

Project

Crowne Plaza He Fei

Area:

Presidential Suite Sanitary

Item:

Shower Set

Issued: 17-Dec-10

Project	5908
---------	------

Scale	NTS
-------	-----

By	TK
----	----

Item No.	BHX-313
----------	----------------



HBA

HIRSCH/BEDNER
ASSOCIATES
DESIGN CONSULTANTS

17/ 46 DOUGLAS ST.
MILTON 4064
QUEENSLAND
AUSTRALIA
FAX 62.3858.5699
■ TEL 617.3858.5688 ■
www.HBAdesign.com



Sea 海

JT016373P11

Shower combination consists of

JC030313P11
Head rain shower

JT016327P11
Concealed bath/shower mixer with locking device

JC030110P11
Shower set

JT000795P11
Wall union

Issued: 17-Dec-10

Project

Crowne Plaza He Fei

Area:

Presidential Suite Sanitary

Item:

Shower Set

Project	5908
Scale	NTS
By	TK
Item No.	BHX-313

SPECIFICATION



HBA

HIRSCH/BEDNER
ASSOCIATES
DESIGN CONSULTANTS

17/ 46 DOUGLAS ST.
MILTON 4064
QUEENSLAND
AUSTRALIA
FAX 62.3858.5699
■ TEL 617.3858.5688 ■
www.HBAdesign.com

MUST BE OF CONTRACT QUALITY AND SUITABLE FOR COMMERCIAL
USE. FABRICATION TO BE IN ACCORDANCE WITH HBA PREAMBLES
(www.hbadesign.com/preambles.html) AND AS FOLLOWS:

Project

Crowne Plaza He Fei

Area:

Presidential Suite Sanitary

Item:

...Open...

Issued: 17-Dec-10

Project	5908
Qty.	
Item No.	BH-314

SPECIFICATION

Mfg. To Be Manufactured Locally

Rep. Or Equal



HBA

HIRSCH/BEDNER
ASSOCIATES
DESIGN CONSULTANTS

17/ 46 DOUGLAS ST.
MILTON 4064
QUEENSLAND
AUSTRALIA
FAX 62.3858.5699
TEL 617.3858.5688
www.HBAdesign.com

MUST BE OF CONTRACT QUALITY AND SUITABLE FOR COMMERCIAL
USE. FABRICATION TO BE IN ACCORDANCE WITH HBA PREAMBLES
(www.hbadesign.com/preambles.html) AND AS FOLLOWS:

1. Description描述: Hand Towel Rail.
2. Location: Bathroom Vanity. Refer to Plans and Elevations for exact locations and quantities.
位置: 浴室洗面台. 確切安裝位置及數量請參閱平面及立面圖.
3. Refer to BHX-315 for details.
有关设计概念, 参阅BHX-315.
4. Model模型: Custom.
5. Dimensions尺寸: 260mm W x 30mm D x 20mm H. As per manufacturer.
6. Finish材質: Polished Chrome.
7. Manufacturer to submit sample to HBA for approval prior to production.
制造前, 制造商必须呈交样板给于H B A批准。
8. Shipping: Must be sufficiently crated/packed/ taped to prevent any damage or breakages.
运输: 必须恰当的箱起/包扎/粘起以防任何的破裂。
9. Must be contract quality and suitable for commercial use.
必须是符合合约的水准并适合商业用途。
10. All item quantites are to be confirmed by operator on site prior to construction.
制造商必须於動工前确认所有数量的需求。
11. All custom designed materials must be coordinated and confirmed by HBA prior to fabrication
by contractor.
任何訂製材料務必在承包商製作前與 HBA 協調及最後設計確認。

Issued: 17-Dec-10

Project

Crowne Plaza He Fei

Area:

Presidential Suite Sanitary

Item:

Hand Towel Rail - L

Project	5908
Qty.	6 Each
Item No.	BH-315



HBA

HIRSCH/BEDNER
ASSOCIATES
DESIGN CONSULTANTS

17/ 46 DOUGLAS ST.
MILTON 4064
QUEENSLAND
AUSTRALIA
FAX 62.3858.5699
■ TEL 617.3858.5688 ■
www.HBAdesign.com



Issued: 17-Dec-10

Project

Crowne Plaza He Fei

Area:

Presidential Suite Sanitary

Item:

Hand Towel Rail - L

Project	5908
Scale	NTS
By	PS
Item No.	BHX-315

SPECIFICATION

Mfg. To Be Manufactured Locally

Rep. Or Equal



HBA

HIRSCH/BEDNER
ASSOCIATES
DESIGN CONSULTANTS

17/ 46 DOUGLAS ST.
MILTON 4064
QUEENSLAND
AUSTRALIA
FAX 62.3858.5699
TEL 617.3858.5688
www.HBAdesign.com

MUST BE OF CONTRACT QUALITY AND SUITABLE FOR COMMERCIAL USE. FABRICATION TO BE IN ACCORDANCE WITH HBA PREAMBLES (www.hbadesign.com/preambles.html) AND AS FOLLOWS:

1. Description描述: Hand Towel Rail.
2. Location: Powder Room. Refer to Plans and Elevations for exact locations and quantities.
位置: 化妝間. 確切安裝位置及數量請參閱平面及立面圖.
3. Refer to BHX-316 for details.
有关设计概念, 参阅BHX-316.
4. Model模型: Custom.
5. Dimensions尺寸: 200mm W x 30mm D x 20mm H. As per manufacturer.
6. Finish材質: Polished Chrome.
7. Manufacturer to submit sample to HBA for approval prior to production.
制造前, 制造商必须呈交样板给于H B A批准。
8. Shipping: Must be sufficiently crated/packed/ taped to prevent any damage or breakages.
运输: 必须恰当的箱起/包扎/粘起以防任何的破裂。
9. Must be contract quality and suitable for commercial use.
必须是符合合约的水准并适合商业用途。
10. All item quantites are to be confirmed by operator on site prior to construction.
制造商必须於動工前确认所有数量的需求。
11. All custom designed materials must be coordinated and confirmed by HBA prior to fabrication by contractor.
任何訂製材料務必在承包商製作前與 HBA 協調及最後設計確認。

Issued: 17-Dec-10

Project

Crowne Plaza He Fei

Area:

Presidential Suite Sanitary

Item:

Hand Towel Rail - S

Project	5908
Qty.	3 Each
Item No.	BH-316



HBA

HIRSCH/BEDNER
ASSOCIATES
DESIGN CONSULTANTS

17/ 46 DOUGLAS ST.
MILTON 4064
QUEENSLAND
AUSTRALIA
FAX 62.3858.5699
■ TEL 617.3858.5688 ■
www.HBAdesign.com



Issued: 17-Dec-10

Project

Crowne Plaza He Fei

Area:

Presidential Suite Sanitary

Item:

Hand Towel Rail - S

Project	5908
Scale	NTS
By	TK
Item No.	BHX-316



HBA

HIRSCH/BEDNER
ASSOCIATES
DESIGN CONSULTANTS

17/ 46 DOUGLAS ST.
MILTON 4064
QUEENSLAND
AUSTRALIA
FAX 62.3858.5699
■ TEL 617.3858.5688 ■
www.HBAdesign.com

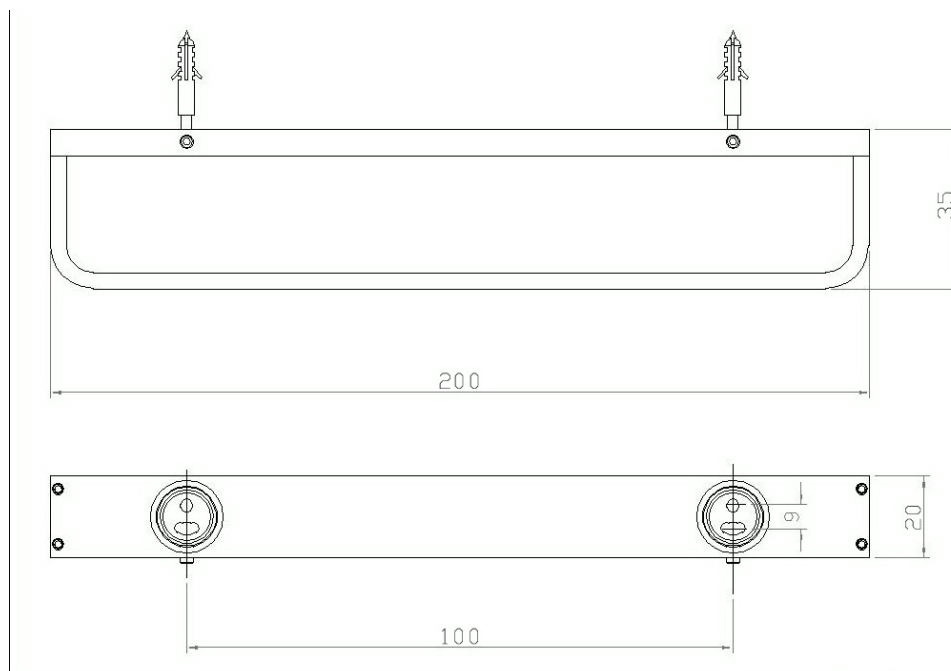

Issued: 17-Dec-10

Project

Crowne Plaza He Fei

Area:

Presidential Suite Sanitary

Item:

Hand Towel Rail - S

Project	5908
Scale	NTS
By	TK
Item No.	BHX-316

SPECIFICATION



HBA

HIRSCH/BEDNER
ASSOCIATES
DESIGN CONSULTANTS

17/ 46 DOUGLAS ST.
MILTON 4064
QUEENSLAND
AUSTRALIA
FAX 62.3858.5699
TEL 617.3858.5688
www.HBAdesign.com

Mfg. Goldiden Industries Co., Ltd.
江華路采華苑 1 棟 3-4 樓
江門市, 廣東省 529000 China
www.goldiden.com

T +86 75 0316 8222 #68
F +86 75 0316 8737
c Johnny Chen 陈永強
e cyq--168@163.com

Rep. Goldiden Industries Co., Ltd.
江華路采華苑 1 棟 3-4 樓
江門市, 廣東省 529000 China
www.goldiden.com

T +86 75 0316 8222 #68
F +86 75 0316 8737
c Johnny Chen 陈永強
e cyq--168@163.com

MUST BE OF CONTRACT QUALITY AND SUITABLE FOR COMMERCIAL
USE. FABRICATION TO BE IN ACCORDANCE WITH HBA PREAMBLES
(www.hbadesign.com/preambles.html) AND AS FOLLOWS:

1. Description描述: Paper Roll Holder.
2. Location: Master Bathroom & Powder Room. Refer to Plans and Elevations for exact locations and quantities.
位置: 主人浴室&化妝間. 確切安裝位置及數量請參閱平面及立面圖.
3. Refer to BHX-317 for details.
有关设计概念, 参阅BHX-317.
4. Model模型: Yo JC561260P11.
5. Dimensions尺寸: 145mm W x 86mm D x 30mm H. As per manufacturer.
6. Finish材質: Polished Chrome.
7. Manufacturer to submit sample to HBA for approval prior to production.
制造前, 制造商必须呈交样板给于HBA批准。
8. Shipping: Must be sufficiently crated/packed/ taped to prevent any damage or breakages.
运输: 必须恰当的箱起/包扎/粘起以防任何的破裂。
9. Must be contract quality and suitable for commercial use.
必须是符合合约的水准并适合商业用途。
10. All item quantites are to be confirmed by operator on site prior to construction.
制造商必须於動工前确认所有数量的需求。
11. All custom designed materials must be coordinated and confirmed by HBA prior to fabrication by contractor.
任何訂製材料務必在承包商製作前與HBA協調及最後設計確認。

Issued: 17-Dec-10

Project

Crowne Plaza He Fei

Area:

Presidential Suite Sanitary

Item:

Paper Roll Holder

Project

5908

Qty.

2 Each

Item
No.

BH-317



HBA

HIRSCH/BEDNER
ASSOCIATES
DESIGN CONSULTANTS

17/ 46 DOUGLAS ST.
MILTON 4064
QUEENSLAND
AUSTRALIA
FAX 62.3858.5699
■ TEL 617.3858.5688 ■
www.HBAdesign.com



Issued: 17-Dec-10

Project

Crowne Plaza He Fei

Area:

Presidential Suite Sanitary

Item:

Paper Roll Holder

Project	5908
Scale	NTS
By	TK
Item No.	BHX-317



HBA

HIRSCH/BEDNER
ASSOCIATES
DESIGN CONSULTANTS

17/ 46 DOUGLAS ST.
MILTON 4064
QUEENSLAND
AUSTRALIA
FAX 62.3858.5699
■ TEL 617.3858.5688 ■
www.HBAdesign.com

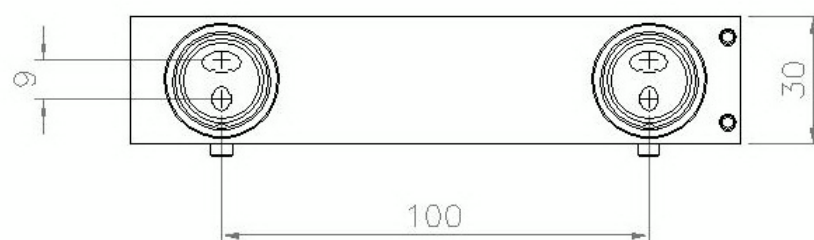
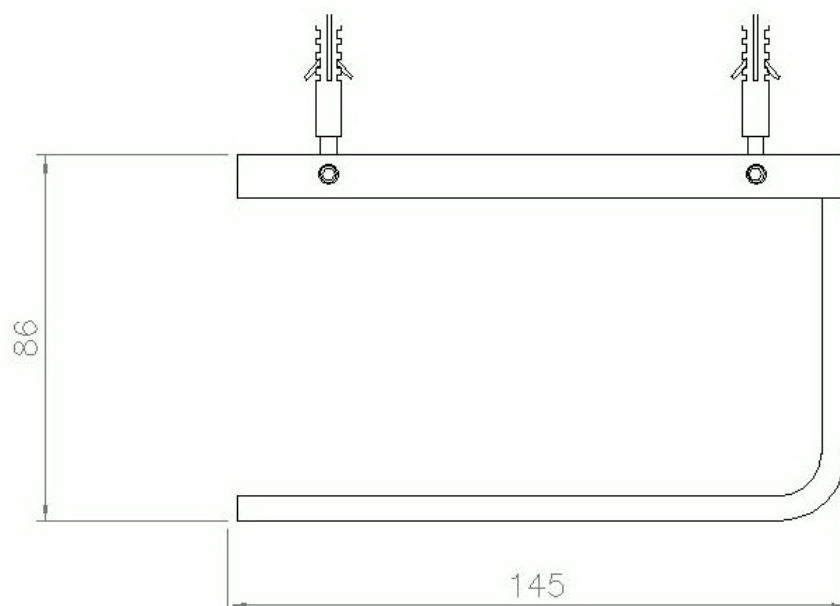

JC561260P11

Issued: 17-Dec-10

Project

Crowne Plaza He Fei

Area:

Presidential Suite Sanitary

Item:

Paper Roll Holder

Project	5908
Scale	NTS
By	TK
Item No.	BHX-317

SPECIFICATION



HBA

HIRSCH/BEDNER
ASSOCIATES
DESIGN CONSULTANTS

17/ 46 DOUGLAS ST.
MILTON 4064
QUEENSLAND
AUSTRALIA
FAX 62.3858.5699
TEL 617.3858.5688
www.HBAdesign.com

Mfg. Goldiden Industries Co., Ltd.
江華路采華苑 1 棟 3-4 樓
江門市, 廣東省 529000 China
www.goldiden.com

T +86 75 0316 8222 #68
F +86 75 0316 8737
c Johnny Chen 陈永強
e cyq--168@163.com

Rep. Goldiden Industries Co., Ltd.
江華路采華苑 1 棟 3-4 樓
江門市, 廣東省 529000 China
www.goldiden.com

T +86 75 0316 8222 #68
F +86 75 0316 8737
c Johnny Chen 陈永強
e cyq--168@163.com

MUST BE OF CONTRACT QUALITY AND SUITABLE FOR COMMERCIAL
USE. FABRICATION TO BE IN ACCORDANCE WITH HBA PREAMBLES
(www.hbadesign.com/preambles.html) AND AS FOLLOWS:

1. Description描述: Spare Paper Roll Holder.
2. Location: Master Bathroom & Powder Room. Refer to Plans and Elevations for exact locations and quantities.
位置: 主人浴室&化妝間. 確切安裝位置及數量請參閱平面及立面圖.
3. Refer to BHX-318 for details.
有关设计概念, 参阅BHX-318.
4. Model模型: Yo JC561261P11.
5. Dimensions尺寸: 142mm W x 106mm D x 30mm H. As per manufacturer.
6. Finish材質: Polished Chrome.
7. Manufacturer to submit sample to HBA for approval prior to production.
制造前, 制造商必须呈交样板给于HBA批准。
8. Shipping: Must be sufficiently crated/packed/ taped to prevent any damage or breakages.
运输: 必须恰当的箱起/包扎/粘起以防任何的破裂。
9. Must be contract quality and suitable for commercial use.
必须是符合合约的水准并适合商业用途。
10. All item quantities are to be confirmed by operator on site prior to construction.
制造商必须於動工前确认所有数量的需求。
11. All custom designed materials must be coordinated and confirmed by HBA prior to fabrication by contractor.
任何訂製材料務必在承包商製作前與HBA協調及最後設計確認。

Issued: 17-Dec-10

Project

Crowne Plaza He Fei

Area:

Presidential Suite Sanitary

Item:

Spare Paper Roll Holder

Project	5908
Qty.	2 Each
Item No.	BH-318



HBA

HIRSCH/BEDNER
ASSOCIATES
DESIGN CONSULTANTS

17/ 46 DOUGLAS ST.
MILTON 4064
QUEENSLAND
AUSTRALIA
FAX 62.3858.5699
■ TEL 617.3858.5688 ■
www.HBAdesign.com



Issued: 17-Dec-10

Project

Crowne Plaza He Fei

Area:

Presidential Suite Sanitary

Item:

Spare Paper Roll Holder

Project	5908
Scale	NTS
By	TK
Item No.	BHX-318



HBA

HIRSCH/BEDNER
ASSOCIATES
DESIGN CONSULTANTS

17/ 46 DOUGLAS ST.
MILTON 4064
QUEENSLAND
AUSTRALIA
FAX 62.3858.5699
■ TEL 617.3858.5688 ■
www.HBAdesign.com

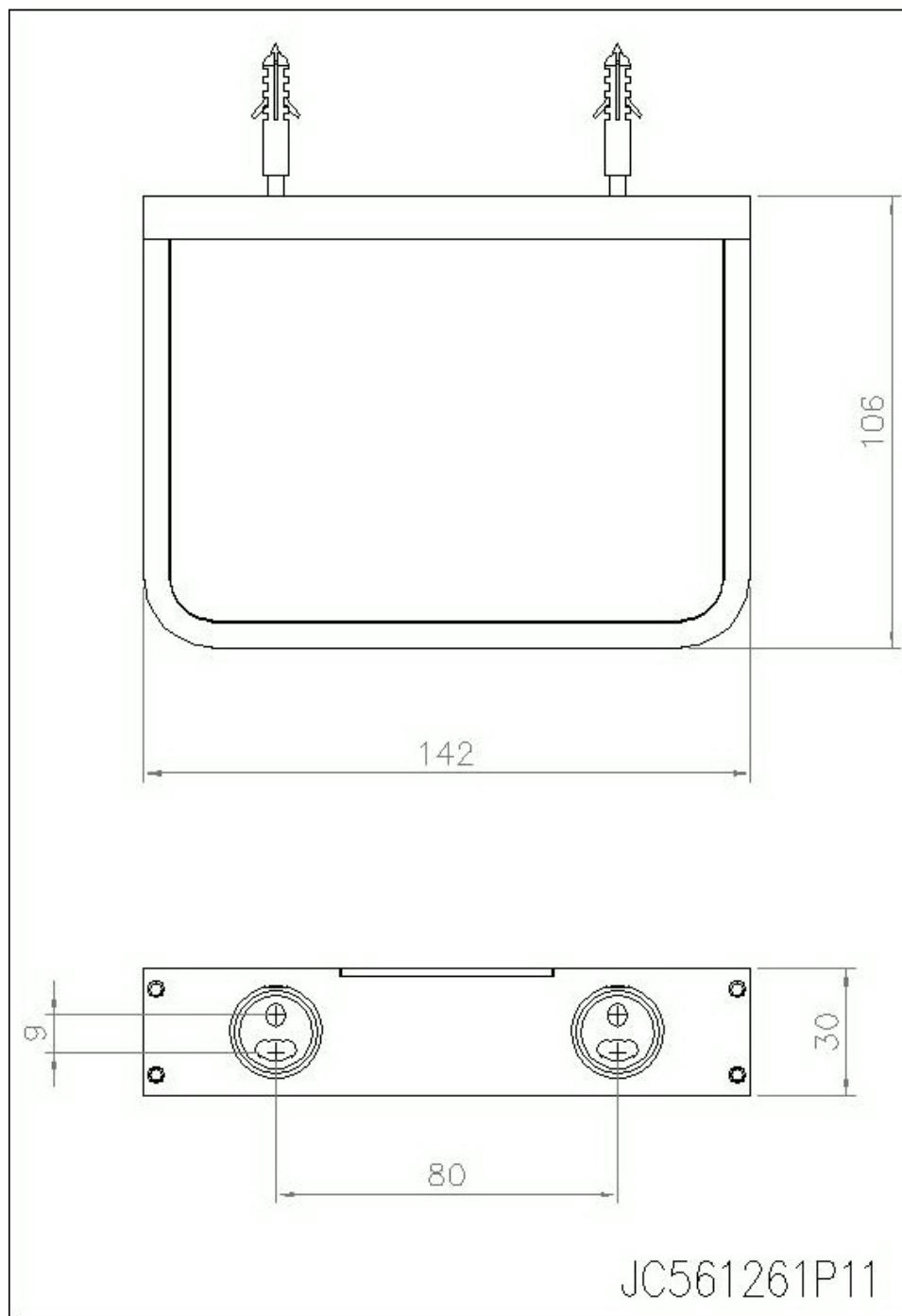

Project

Crowne Plaza He Fei

Area:

Presidential Suite Sanitary

Item:

Spare Paper Roll Holder

Issued: 17-Dec-10

Project	5908
Scale	NTS
By	TK
Item No.	BHX-318

SPECIFICATION



HBA

HIRSCH/BEDNER
ASSOCIATES
DESIGN CONSULTANTS

17/ 46 DOUGLAS ST.
MILTON 4064
QUEENSLAND
AUSTRALIA
FAX 62.3858.5699
TEL 617.3858.5688
www.HBAdesign.com

Mfg. Goldiden Industries Co., Ltd.
江華路采華苑 1 棟 3-4 樓
江門市, 廣東省 529000 China
www.goldiden.com

T +86 75 0316 8222 #68
F +86 75 0316 8737
c Johnny Chen 陈永強
e cyq--168@163.com

Rep. Goldiden Industries Co., Ltd.
江華路采華苑 1 棟 3-4 樓
江門市, 廣東省 529000 China
www.goldiden.com

T +86 75 0316 8222 #68
F +86 75 0316 8737
c Johnny Chen 陈永強
e cyq--168@163.com

MUST BE OF CONTRACT QUALITY AND SUITABLE FOR COMMERCIAL
USE. FABRICATION TO BE IN ACCORDANCE WITH HBA PREAMBLES
(www.hbadesign.com/preambles.html) AND AS FOLLOWS:

1. Description描述: Robe Hook.
2. Location: Master Bathroom & Powder Room. Refer to Plans and Elevations for exact locations and quantities.
位置: 主人浴室&化妝間. 確切安裝位置及數量請參閱平面及立面圖.
3. Refer to BHX-319 for details.
有关设计概念, 参阅BHX-319.
4. Model模型: Fen JC564210P11.
5. Dimensions尺寸: 60mm W x 45mm D x 14mm H. As per manufacturer.
6. Finish材質: Polished Chrome.
7. Manufacturer to submit sample to HBA for approval prior to production.
制造前, 制造商必须呈交样板给于HBA批准。
8. Shipping: Must be sufficiently crated/packed/ taped to prevent any damage or breakages.
运输: 必须恰当的箱起/包扎/粘起以防任何的破裂。
9. Must be contract quality and suitable for commercial use.
必须是符合合约的水准并适合商业用途。
10. All item quantities are to be confirmed by operator on site prior to construction.
制造商必须於動工前确认所有数量的需求。
11. All custom designed materials must be coordinated and confirmed by HBA prior to fabrication by contractor.
任何訂製材料務必在承包商製作前與HBA協調及最後設計確認。

Issued: 17-Dec-10

Project

Crowne Plaza He Fei

Area:

Presidential Suite Sanitary

Item:

Robe Hook

Project	5908
Qty.	3 Each
Item No.	BH-319



HBA

HIRSCH/BEDNER
ASSOCIATES
DESIGN CONSULTANTS

17/ 46 DOUGLAS ST.
MILTON 4064
QUEENSLAND
AUSTRALIA
FAX 62.3858.5699
■ TEL 617.3858.5688 ■
www.HBAdesign.com

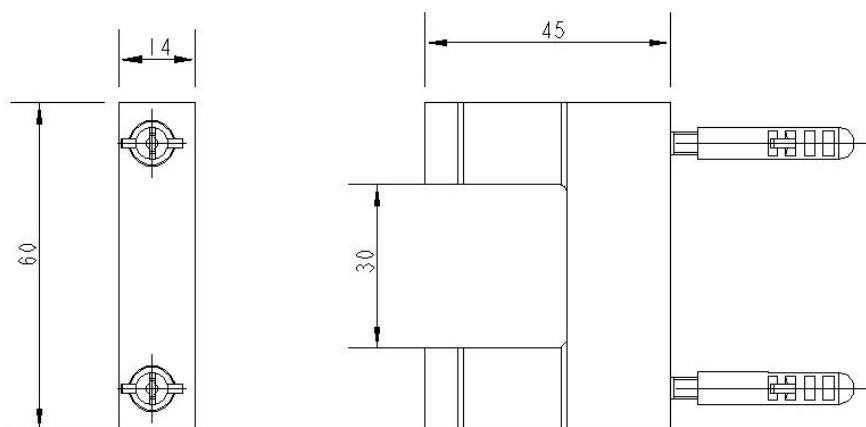

JC564210P11

Issued: 17-Dec-10

Project

Crowne Plaza He Fei

Area:

Presidential Suite Sanitary

Item:

Robe Hook

Project	5908
Scale	NTS
By	TK
Item No.	BHX-319



HBA

HIRSCH/BEDNER
ASSOCIATES
DESIGN CONSULTANTS

17/ 46 DOUGLAS ST.
MILTON 4064
QUEENSLAND
AUSTRALIA
FAX 62.3858.5699
■ TEL 617.3858.5688 ■
www.HBAdesign.com



Issued: 17-Dec-10

Project

Crowne Plaza He Fei

Area:

Presidential Suite Sanitary

Item:

Robe Hook

Project	5908
Scale	NTS
By	TK
Item No.	BHX-319

SPECIFICATION



HBA

HIRSCH/BEDNER
ASSOCIATES
DESIGN CONSULTANTS

17/ 46 DOUGLAS ST.
MILTON 4064
QUEENSLAND
AUSTRALIA
FAX 62.3858.5699
TEL 617.3858.5688
www.HBAdesign.com

Mfg. GEESA Bathroom Accessories
P.O.Box 477
Vanadiumweg 2
3800 AL Amersfoort, Holland
Netherlands
www.geesa.nl

T +31 033 463 3214
F +31 033 463 7186
c Marc Goosen
e m.goosen@geesa.nl

Rep. Massford Ltd. (Hong Kong)
17/F First Commercial Building
33 Leighton Road
Causeway Bay
Hong Kong, China

T +852 2891 6860
F +852 2834 3029
c Anita Fung
e anitafung@massford.com

MUST BE OF CONTRACT QUALITY AND SUITABLE FOR COMMERCIAL
USE. FABRICATION TO BE IN ACCORDANCE WITH HBA PREAMBLES
(www.hbadesign.com/preambles.html) AND AS FOLLOWS:

1. Description描述: Grooming Mirror.
2. Location: Master Bathroom & Powder Room. Refer to Plans and Elevations for exact locations and quantities.
位置: 主人浴室&化妝間. 確切安裝位置及數量請參閱平面及立面圖.
3. Refer to BHX-320 for details.
有关设计概念, 参阅BHX-320.
4. Model模型: 1093.
5. Dimensions尺寸: 215mm DIA x 290mm D x 120mm H. As per manufacturer.
6. Finish材質: Polished Chrome.
7. Manufacturer to submit sample to HBA for approval prior to production.
制造前, 制造商必须呈交样板给于HBA批准。
8. Shipping: Must be sufficiently crated/packed/ taped to prevent any damage or breakages.
运输: 必须恰当的箱起/包扎/粘起以防任何的破裂。
9. Must be contract quality and suitable for commercial use.
必须是符合合约的水准并适合商业用途。
10. All item quantities are to be confirmed by operator on site prior to construction.
制造商必须於動工前确认所有数量的需求。
11. All custom designed materials must be coordinated and confirmed by HBA prior to fabrication by contractor.
任何訂製材料務必在承包商製作前與HBA協調及最後設計確認。

Issued: 17-Dec-10

Project

Crowne Plaza He Fei

Area:

Presidential Suite Sanitary

Item:

Grooming Mirror

Project	5908
Qty.	2 Each
Item No.	BH-320



HBA

HIRSCH/BEDNER
ASSOCIATES
DESIGN CONSULTANTS

17/ 46 DOUGLAS ST.
MILTON 4064
QUEENSLAND
AUSTRALIA
FAX 62.3858.5699
■ TEL 617.3858.5688 ■
www.HBAdesign.com

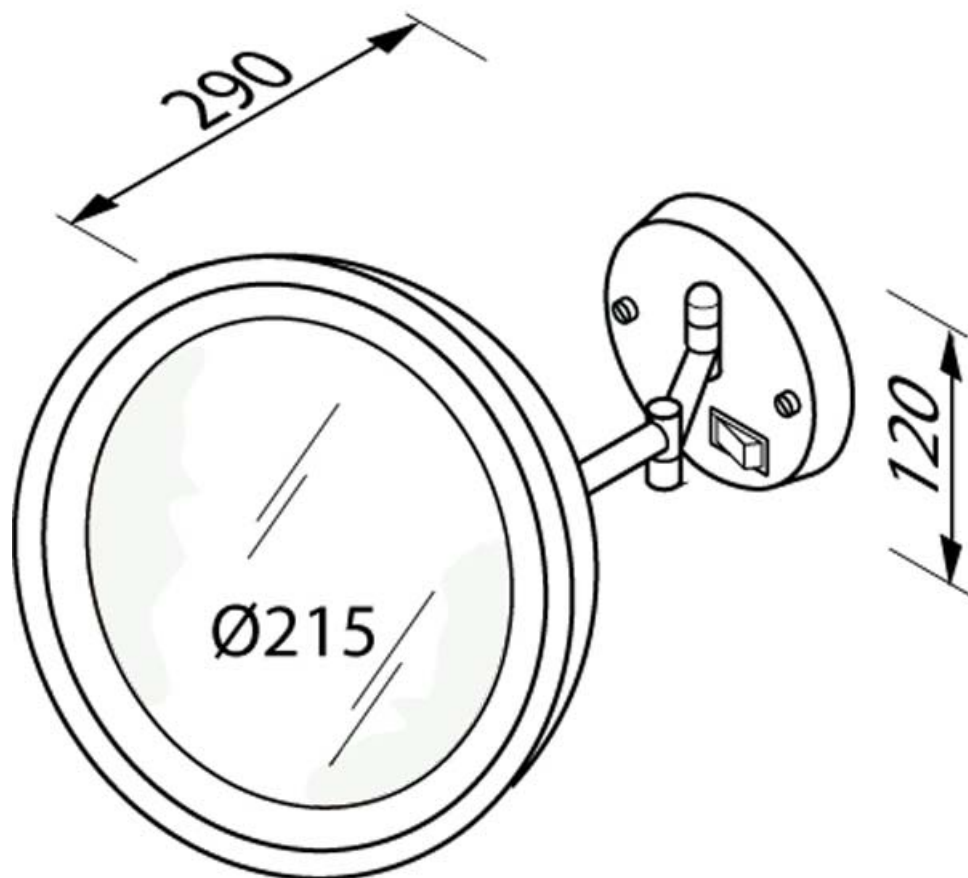

Project

Crowne Plaza He Fei

Area:

Presidential Suite Sanitary

Item:

Grooming Mirror

Issued: 17-Dec-10

Project	5908
Scale	NTS
By	TK
Item No.	BHX-320



HBA

HIRSCH/BEDNER
ASSOCIATES
DESIGN CONSULTANTS

17/ 46 DOUGLAS ST.
MILTON 4064
QUEENSLAND
AUSTRALIA
FAX 62.3858.5699
■ TEL 617.3858.5688 ■
www.HBAdesign.com



Issued: 17-Dec-10

Project

Crowne Plaza He Fei

Area:

Presidential Suite Sanitary

Item:

Grooming Mirror

Project	5908
Scale	NTS
By	TK
Item No.	BHX-320

SPECIFICATION



HBA

HIRSCH/BEDNER
ASSOCIATES
DESIGN CONSULTANTS

17/ 46 DOUGLAS ST.
MILTON 4064
QUEENSLAND
AUSTRALIA
FAX 62.3858.5699
■ TEL 617.3858.5688 ■
www.HBAdesign.com

MUST BE OF CONTRACT QUALITY AND SUITABLE FOR COMMERCIAL
USE. FABRICATION TO BE IN ACCORDANCE WITH HBA PREAMBLES
(www.hbadesign.com/preambles.html) AND AS FOLLOWS:

Project

Crowne Plaza He Fei

Area:

Presidential Suite Sanitary

Item:

...Open...

Issued: 17-Dec-10

Project	5908
Qty.	
Item No.	BH-321

SPECIFICATION



HBA

HIRSCH/BEDNER
ASSOCIATES
DESIGN CONSULTANTS

17/ 46 DOUGLAS ST.
MILTON 4064
QUEENSLAND
AUSTRALIA
FAX 62.3858.5699
■ TEL 617.3858.5688 ■
www.HBAdesign.com

MUST BE OF CONTRACT QUALITY AND SUITABLE FOR COMMERCIAL
USE. FABRICATION TO BE IN ACCORDANCE WITH HBA PREAMBLES
(www.hbadesign.com/preambles.html) AND AS FOLLOWS:

Project

Crowne Plaza He Fei

Area:

Presidential Suite Sanitary

Item:

...Open...

Issued: 17-Dec-10

Project	5908
Qty.	
Item No.	BH-322

SPECIFICATION



HBA

HIRSCH/BEDNER
ASSOCIATES
DESIGN CONSULTANTS

17/ 46 DOUGLAS ST.
MILTON 4064
QUEENSLAND
AUSTRALIA
FAX 62.3858.5699
TEL 617.3858.5688
www.HBAdesign.com

Mfg.	Shanghai Bagen Electronic & Technology 2F/D Building No. 3601 DongFang Road Shanghai, 200125 China www.beign.com	T	+86 21 5090 7817
		F	+86 21 5090 7817
		e	beign@126.com
Rep.	Shanghai Bagen Electronic & Technology 2F/D Building No. 3601 DongFang Road Shanghai, 200125 China www.beign.com	T	+86 21 5090 7817
		F	+86 21 5090 7817
		e	beign@126.com

MUST BE OF CONTRACT QUALITY AND SUITABLE FOR COMMERCIAL USE. FABRICATION TO BE IN ACCORDANCE WITH HBA PREAMBLES (www.hbadesign.com/preambles.html) AND AS FOLLOWS:

1. Description描述: Rectangular Mirror Defogger.
2. Location: Master Bathroom Mirror. Refer to Plans and Elevations for exact locations and quantities.
位置: 主人浴室鏡子. 確切安裝位置及數量請參閱平面及立面圖.
3. Refer to BHX-323 for details.
有关设计概念, 参阅BHX-323.
4. Model模型: R-3040.
5. Dimensions尺寸: 750mm W x 1000mm L.
6. Finish材質: As per manufacturer.
7. Manufacturer to submit sample to HBA for approval prior to production.
制造前, 制造商必须呈交样板给于HBA批准。
8. Shipping: Must be sufficiently crated/packed/ taped to prevent any damage or breakages.
运输: 必须恰当的箱起/包扎/粘起以防任何的破裂。
9. Must be contract quality and suitable for commercial use.
必须是符合合约的水准并适合商业用途。
10. All item quantites are to be confirmed by operator on site prior to construction.
制造商必须於動工前确认所有数量的需求。
11. All custom designed materials must be coordinated and confirmed by HBA prior to fabrication by contractor.
任何訂製材料務必在承包商製作前與HBA協調及最後設計確認。

Issued: 17-Dec-10

Project

Crowne Plaza He Fei

Area:

Presidential Suite Sanitary

Item:

Mirror Defogger

Project	5908
Qty.	2 Each
Item No.	BH-323



HBA

HIRSCH/BEDNER
ASSOCIATES
DESIGN CONSULTANTS

17/ 46 DOUGLAS ST.
MILTON 4064
QUEENSLAND
AUSTRALIA
FAX 62.3858.5699
■ TEL 617.3858.5688 ■
www.HBAdesign.com



Project

Crowne Plaza He Fei

Area:

Presidential Suite Sanitary

Item:

Mirror Defogger

Issued: 17-Dec-10

Project	5908
Scale	NTS
By	TK
Item No.	BHX-323

SPECIFICATION



HBA

HIRSCH/BEDNER
ASSOCIATES
DESIGN CONSULTANTS

17/ 46 DOUGLAS ST.
MILTON 4064
QUEENSLAND
AUSTRALIA
FAX 62.3858.5699
TEL 617.3858.5688
www.HBAdesign.com

Mfg. Toto (East China)
延安西路 2201号
上海国际贸易中心210室
Shanghai, China
www.toto.com.cn

T +86 21 6270 1010 #161
F +86 21 6270 3099 #161
c Liang Chen 陳良
e chenliang@toto.com.cn

Rep. Toto (East China)
延安西路 2201号
上海国际贸易中心210室
Shanghai, China
www.toto.com.cn

T +86 21 6270 1010 #161
F +86 21 6270 3099 #161
c Liang Chen 陳良
e chenliang@toto.com.cn

MUST BE OF CONTRACT QUALITY AND SUITABLE FOR COMMERCIAL
USE. FABRICATION TO BE IN ACCORDANCE WITH HBA PREAMBLES
(www.hbadesign.com/preambles.html) AND AS FOLLOWS:

1. Description描述: Drain System.
2. Location: Master Bathroom. Refer to Plans and Elevations for exact locations and quantities.
位置: 主人浴室. 確切安裝位置及數量請參閱平面及立面圖.
3. Refer to BHX-324 for details.
有关设计概念, 参阅BHX-324.
4. Model模型: YTB800D.
5. Dimensions尺寸: 796mm W x 196mm D.
6. Finish材質: Polished Chrome.
7. Manufacturer to submit sample to HBA for approval prior to production.
制造前, 制造商必须呈交样板给于HBA批准。
8. Shipping: Must be sufficiently crated/packed/ taped to prevent any damage or breakages.
运输: 必须恰当的箱起/包扎/粘起以防任何的破裂。
9. Must be contract quality and suitable for commercial use.
必须是符合合约的水准并适合商业用途。
10. All item quantites are to be confirmed by operator on site prior to construction.
制造商必须於動工前确认所有数量的需求。
11. All custom designed materials must be coordinated and confirmed by HBA prior to fabrication
by contractor.
任何訂製材料務必在承包商製作前與 HBA 協調及最後設計確認。

Issued: 17-Dec-10

Project

Crowne Plaza He Fei

Area:

Presidential Suite Sanitary

Item:

Drain System

Project	5908
Qty.	1 Each
Item No.	BH-324



HBA

HIRSCH/BEDNER
ASSOCIATES
DESIGN CONSULTANTS

17/ 46 DOUGLAS ST.
MILTON 4064
QUEENSLAND
AUSTRALIA
FAX 62.3858.5699
■ TEL 617.3858.5688 ■
www.HBAdesign.com

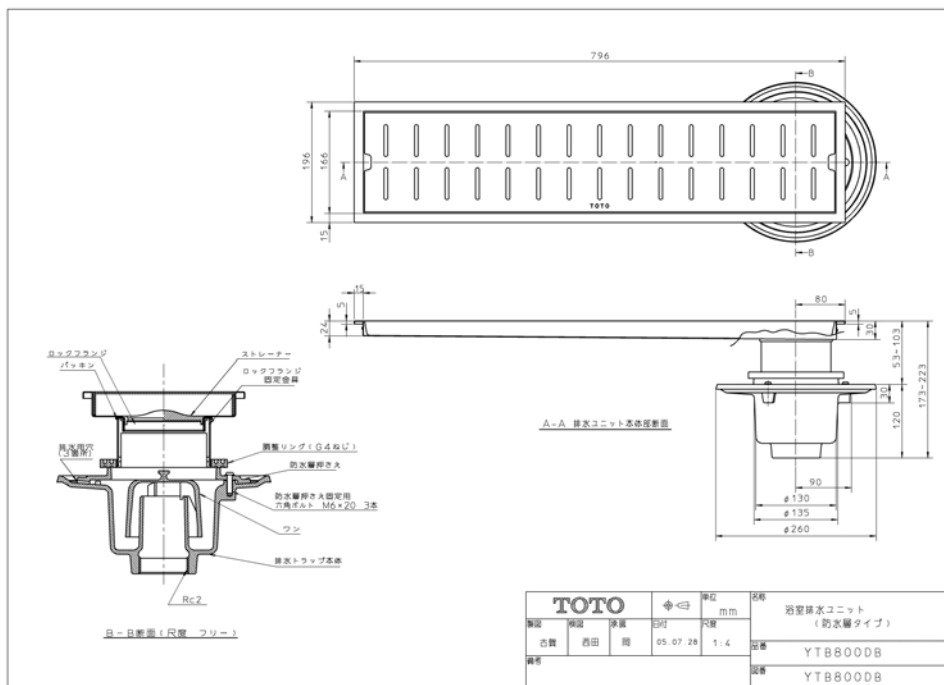

Project

Crowne Plaza He Fei

Area:

Presidential Suite Sanitary

Item:

Drain System

Issued: 17-Dec-10

Project	5908
Scale	NTS
By	TK
Item No.	BHX-324



HBA

HIRSCH/BEDNER
ASSOCIATES
DESIGN CONSULTANTS

17/ 46 DOUGLAS ST.
MILTON 4064
QUEENSLAND
AUSTRALIA
FAX 62.3858.5699
■ TEL 617.3858.5688 ■
www.HBAdesign.com



Issued: 17-Dec-10

Project

Crowne Plaza He Fei

Area:

Presidential Suite Sanitary

Item:

Drain System

Project	5908
Scale	NTS
By	TK
Item No.	BHX-324

SPECIFICATION



HBA

HIRSCH/BEDNER
ASSOCIATES
DESIGN CONSULTANTS

17/ 46 DOUGLAS ST.
MILTON 4064
QUEENSLAND
AUSTRALIA
FAX 62.3858.5699
TEL 617.3858.5688
www.HBAdesign.com

Mfg. Toto (East China)
延安西路 2201号
上海国际贸易中心210室
Shanghai, China
www.toto.com.cn

T +86 21 6270 1010 #161
F +86 21 6270 3099 #161
c Liang Chen 陳良
e chenliang@toto.com.cn

Rep. Toto (East China)
延安西路 2201号
上海国际贸易中心210室
Shanghai, China
www.toto.com.cn

T +86 21 6270 1010 #161
F +86 21 6270 3099 #161
c Liang Chen 陳良
e chenliang@toto.com.cn

MUST BE OF CONTRACT QUALITY AND SUITABLE FOR COMMERCIAL
USE. FABRICATION TO BE IN ACCORDANCE WITH HBA PREAMBLES
(www.hbadesign.com/preambles.html) AND AS FOLLOWS:

1. Description描述: Floor Trap.
2. Location: Master Bathroom, Powder Room & Kitchen. Refer to Plans and Elevations for exact locations and quantities.
位置: 主人浴室, 化妝間 & 廚房. 確切安裝位置及數量請參閱平面及立面圖.
3. Refer to BHX-325 for details.
有关设计概念, 参阅BHX-325.
4. Model模型: TX 1 BN Floor Drain with Square Flange. Must be supplied with associated hardware suitable for intended use and as recommended by manufacturer for size and weight of individual items.
5. Dimensions尺寸: 115mm W x 115mm D. As per manufacturer.
6. Finish材質: Polished Chrome.
7. Manufacturer to submit sample to HBA for approval prior to production.
制造前, 制造商必须呈交样板给于HBA批准。
8. Shipping: Must be sufficiently crated/packed/ taped to prevent any damage or breakages.
运输: 必须恰当的箱起/包扎/粘起以防任何的破裂。
9. Must be contract quality and suitable for commercial use.
必须是符合合约的水准并适合商业用途。
10. All item quantities are to be confirmed by operator on site prior to construction.
制造商必须於動工前确认所有数量的需求。
11. All custom designed materials must be coordinated and confirmed by HBA prior to fabrication by contractor.
任何訂製材料務必在承包商製作前與HBA協調及最後設計確認。

Issued: 17-Dec-10

Project

Crowne Plaza He Fei

Area:

Presidential Suite Sanitary

Item:

Floor Trap

Project	5908
Qty.	4 Each
Item No.	BH-325



HBA

HIRSCH/BEDNER
ASSOCIATES
DESIGN CONSULTANTS

17/ 46 DOUGLAS ST.
MILTON 4064
QUEENSLAND
AUSTRALIA
FAX 62.3858.5699
■ TEL 617.3858.5688 ■
www.HBAdesign.com

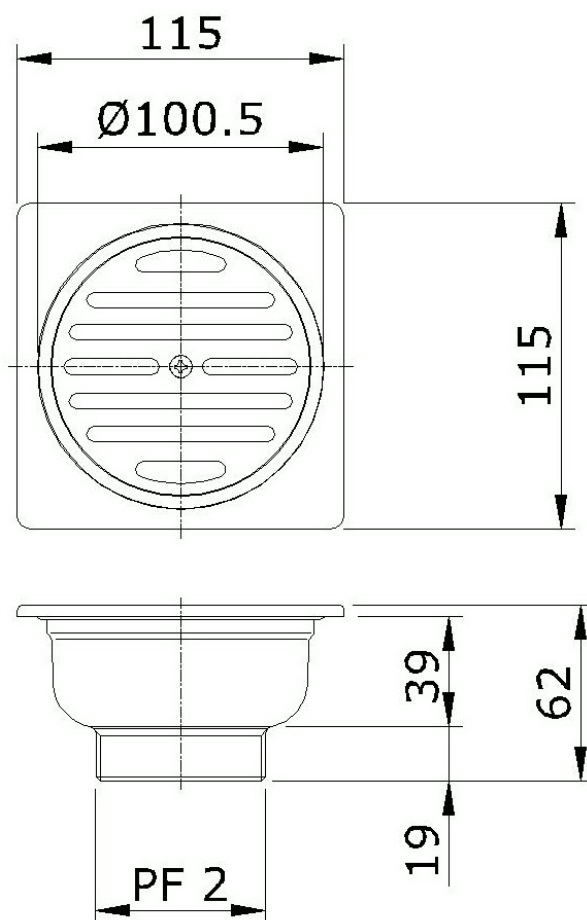

Issued: 17-Dec-10

Project

Crowne Plaza He Fei

Area:

Presidential Suite Sanitary

Item:

Floor Trap

Project	5908
Scale	NTS
By	TK
Item No.	BHX-325



HBA

HIRSCH/BEDNER
ASSOCIATES
DESIGN CONSULTANTS

17/ 46 DOUGLAS ST.
MILTON 4064
QUEENSLAND
AUSTRALIA
FAX 62.3858.5699
■ TEL 617.3858.5688 ■
www.HBAdesign.com



Project

Crowne Plaza He Fei

Area:

Presidential Suite Sanitary

Item:

Floor Trap

Issued: 17-Dec-10

Project	5908
Scale	NTS
By	TK
Item No.	BHX-325